

**Seattle-Tacoma International Airport  
International Arrivals Facility Project  
MC-0318087 / WP# U00059**

**Clark Construction Group  
Request for Proposals- Early Works Projects  
Trade Packages 1A-1E**

May 27, 2016

- 1A – Existing Concourse Renovations**
- 1B – North East Ground Transportation Lot**
- 1C – North East Ground Transportation Lot – Support Facilities**
- 1D – Maki Sculpture Relocation**
- 1E – Low Voltage Systems for Early Works Projects 1A & 1C**

**Proposals are due by 2:00 p.m. on Tuesday June 21, 2016**

# Seattle-Tacoma International Airport International Arrivals Facility Project

MC-0318087 / WP# U00059

## Request for Proposals

### Trade Packages 1A - 1E Work Scope Summary

#### **SEA-TAC INTERNATIONAL ARRIVALS FACILITY (IAF) - PROJECT INTRODUCTION**

Clark Construction Group (CLARK) has been selected as the design-builder for the new Sea-Tac International Arrivals Facility (IAF). This project is Clark Construction's second major undertaking at Sea-Tac Airport with previous completion of the South Terminal Expansion in 2004.

The design team will be led by SOM and Miller Hull Partnership architects and includes the following major partners: ARUP-Planning / Overall MEP; KPFF-Structural; MKA-Civil; Hart Crowser-Geotechnical; Schlaich Bergerman Partners-Bridge; Lerch Bates-Vertical Transportation; BNP-Baggage Handling; Patano Studio Architects; Suehiro Architecture; Luma Lighting-Lighting; Argus-Fueling; FSI-Mechanical / Plumbing specific aspects; Mazzetti-Electrical specific aspects; BRC-Acoustical; Murase-Landscape and O'Brien & Company-Sustainability.

CLARK and its design team have completed the contract documents for Early Works Projects / Trade Packages 1A-1E. We are inviting interested Trade Contractors to submit proposals for these Trade Packages 1A-1E. The following will provide an overview of the IAF Project and Trade Packages 1A-1E:

Major components of the project are identified on the airport aerial (see Appendix 1) and include:

- The new International Arrivals Facility (IAF) is located on the east side of the Concourse A. The existing Federal Inspections Area (commonly known as Customs) dates back to the 1970's and is operating beyond its peak capacity. The new IAF will create a more efficient, higher quality passenger experience, advance the Puget Sound region as a leading tourism and business gateway, and serve the traveling public well into the future. This portion of the project will be constructed in a non-secure area of the airport. (In general, security badges are not required for trades).
- A Pedestrian Bridge will span 800 linear feet over the existing taxi lane, connecting the south satellite to the IAF. It is currently planned that the central span of the bridge (an approximate 300 LF section), will be pre-fabricated within the airport property, moved into place and installed within a seven-day time frame. When complete, the bridge will offer views of Mount Rainier and the Olympic Mountains. This portion of the project will be constructed in a secure area of the airport. (In general, security badges will be required for trades).

- The last major component of the project is an elevated sterile corridor, approximately 40 feet above the apron level, which will connect Gates A3 through A14. The Sterile Corridor will connect to four gate pods, which will interface with Concourse A and include all vertical transportation elements. (In general, security badges will be required for trades).

The project scheduled for completion in the third quarter of 2019, and will be designed to achieve LEED® Silver version 4 certification.

In this specific Request for Proposal for **Trade Packages 1A - 1E** - CLARK is requesting proposals from qualified Trade Contractors for Early Works Projects (See Appendix 2 for Early Works Project locations), which will enable the start of the major construction of the IAF. The general scope for each of these Trade Packages is as follows:

#### **Trade Package 1A–Concourse Renovations:**

- Electrical Shop
  - Renovation of approximately 10,000 sf to allow for new baggage tug lane and egress corridor including demolition, ramped slab on grade, doors, drywall partitions, locker relocation. Also included is the reconfiguration of HVAC, fire protection, plumbing, power, lighting and fire alarm.
- Conveyor Electrical Shop
  - Renovation of approximately 1,500 sf to allow for new conveyor electrical shop. The work in this area includes demolition, topping slab, doors, drywall partitions, ductwork relocation, and addition of a new HVAC unit. Also included is the reconfiguration of fire protection, power, lighting and fire alarm.
- Loading Dock Relocation:
  - Interior and exterior reconfiguration to allow relocation of existing loading dock during construction of IAF. This project includes drywall partition, exterior opening, equipment relocation, doors, bollards and chain link fence. Also included is the reconfiguration of HVAC, fire protection, plumbing, power, lighting and fire alarm.
- United Airlines Admin Egress & Air Service Space
  - Renovation of approximately 1,000 sf to allow for second egress as well as support space. The work in this area includes demolition, drywall partitions, drywall ceiling, and flooring. Also included is the reconfiguration of fire protection, HVAC, power, lighting and fire alarm.

#### **Trade Package 1B–North East Ground Transportation Lot:**

- Rehabilitation of approximately 47,000 sf existing parking lot. Included is asphalt and concrete paving demolition, general excavation, hydrant relocation, storm drain adjustments, asphalt pavement, striping, fence relocation, installation of light poles and landscaping.

#### **Trade Package 1C–North East Ground Transportation Lot Support Facilities:**

- Renovations to approximately 8,000 sf including new countertops, construction of a new communications room, new automatic sliding entry doors, walkway wayfinding/privacy

screen, concrete curb, glass screen walls, relocation of customer stations, lighting and fire alarm.

**Trade Package 1D–Maki Sculpture Relocation:**

- Relocation of Canary II sculpture to site along S 160<sup>th</sup> Street (next to the Rental Car Facility). This project includes rigging and relocation of existing sculpture, grading of new location, new concrete foundation, new lighting and landscape restoration.

**Trade Package 1E–Low Voltage Systems for Early Works Projects**

- Reconfiguration of existing low voltage systems as required in previous listed areas. The systems included, but not limited to, are Wi-Fi, DAS, and Voice Paging.

**AVAILABILITY OF PROPOSAL / CONTRACT DOCUMENTS**

Proposal / Contract Documents for Trade Packages 1A - 1E are available at:  
[www.clarkseataciaf/procurement.com](http://www.clarkseataciaf/procurement.com)

**BONDING AND INSURANCE REQUIREMENTS**

CLARK will require Payment and Performance bonds for this project, for all proposals over \$100,000.00. All Proposals requiring bonds, must be accompanied by a letter of bondability from the surety of the proposing Trade Contractor (See Exhibit C of the Subcontract for Bond Forms).

All Proposals must also submit a letter from your insurance company indicating the ability to procure insurance coverage required for the project (See Exhibit E of the Subcontract for Insurance Requirements).

**SCS AND SBE BUSINESS GOALS**

CLARK is committed to creating contracting opportunities for SCS and SBE business, along with employment opportunities for businesses and individuals that live in the local community. This project includes an overall contract goal of **12% Small Contractor Supplier (SCS) Certified and 17.5% SBE (SCS/MBE/WBE/DBE/DVBE)**.

As an indication of the importance of these goals, SCS and SBE participation is included in the Trade Contractor evaluation criteria (Appendix 3) for work scopes on this project. Please clearly indicate the percentage of SCS and SBE participation that are included within your proposal, along with the names and certifications of any firms that will be utilized on the attached Proposal Form.

Please maintain records of your outreach efforts. Clark reserves the right to review these records during the evaluation of your Proposal.

**EXAMINE CONTRACT DOCUMENTS AND SITE WALK:**

Before submitting a Proposal, Proposers shall carefully examine the Contract Documents; attend the scheduled site walks (to be scheduled by trade as necessary) of the Sea-Tac IAF

site; fully inform themselves as to all existing conditions and limitations, including those of labor availability; progress of work to date, if any. No consideration will be granted for any alleged misunderstanding of the material, article or piece of equipment to be furnished or work to be done; it being understood that the submittal of a Proposal carries with it the agreement to all items and conditions referred to herein or indicated in the Contract Documents.

The Pre Bid Meeting and site walk (not mandatory) for Trade Packages 1A-1E was conducted on May 18, 2016. The presentation and handout of the Pre Bid Meeting is available on [www.clarkseataciaf.com](http://www.clarkseataciaf.com).

An additional site walk for trade packages 1A – 1E is scheduled for Wednesday June 8, 2016 at 9:00 am. Please meet at the CLARK project office at:

17900 International Blvd. Suite 400  
SeaTac WA 98188

PPE is required for this site walk. Each participant will be required to sign a Liability Release prior to participating in the site walk.

While the site walk is highly encouraged it is not mandatory.

### **INTERPRETATIONS, DISCREPANCIES AND OMISSIONS:**

If Proposer has a question in regard to any part of the Contract Documents, Proposer shall submit a written Pre- Proposal Request for Information (RFI) to CLARK, who will coordinate as required with the Architect/Engineer and others for interpretation. Proposer submitting RFI is responsible for its prompt and actual delivery. Neither CLARK, the Architect/Engineer, nor the Port of Seattle is responsible for any explanations or interpretations of such documents which anyone presumes to make, other than by Addenda.

Requests for Information (RFI), they should be submitted on the RFI Form (see Appendix 3) to: [iafprocurement@clarkconstruction.com](mailto:iafprocurement@clarkconstruction.com).

We request that any RFI's be submitted by no later than 5:00 pm on Wednesday, June 15, 2016 to allow for adequate response time from the Clark team in the form of an Addendum.

### **ADDENDA:**

All Addenda issued during the time of proposal preparation, shall become a part of the Contract Documents and receipt thereof shall be listed and acknowledged on the Proposal Form.

### **TRADE CONTRACTOR QUALIFICATION APPLICATION**

If not already completed within the past twelve months, please visit <https://www.clarkextranet.com/databases/subqual.nsf?open&login> and complete a CLARK Subcontractor Qualification Application (SQA) online. prior to submitting your proposal. This application will provide CLARK with the most accurate information by which to evaluate each proposing firm.

### **INSTRUCTIONS FOR SUBMITTING TRADE PACKAGE PROPOSAL**

Each Trade Package Proposal 1A – 1E shall be submitted on the Proposal Form (see Attachment 1), with all blank spaces filled in. Proposal Forms are to be detached from these documents.

Each Trade Package Proposal submission shall include the following:

- a. Fully completed and executed Proposal Form;
- b. Signed Statement of SCS and SBE percent participation and applicable outreach and certification input;
- c. Letter from Surety confirming bondability;
- d. Insurance Verification Letter;
- e. PLA Letter of Assent;
- f. Acknowledgement of receipt of issued Addenda.

### **SCORING PROPOSALS**

Proposals will be evaluated and scored in accordance to the attached IAF Trade Contractor Evaluation Criteria (Appendix#). Proposals that do not meet the minimum pass / fail qualification will not be considered for Contract Award.

*(Note - Proposals **will not** be opened or scored publicly)*

### **WITHDRAWAL OR REVISION OF PROPOSALS:**

Any Proposal may be withdrawn or revised in writing prior to the scheduled time for opening of Proposals. After opening, no Proposal may be withdrawn unless CLARK does not send the Proposer a Subcontract within ninety (90) calendar days after the opening date of the Proposals.

### **RESERVATION OF RIGHTS**

Clark reserves the right to reject any or all Proposals and/or waive any informalities or irregularities, at its discretion, if they have no bearing on the overall evaluation of the Proposal. Additionally we are entitled to request additional supporting information after submittal of the Proposal, if deemed necessary to allow proper evaluation.

**We thank all prospective Trade Contractors in advance for your interest in the project**



**Seattle-Tacoma International Airport  
International Arrivals Facility Project**  
MC-0318087 / WP# U00059

**Request for Proposal**

**Trade Package 1A – Existing Concourse  
Renovations**

**ATTACHMENT 1**

**SEA TAC IAF**  
**Trade Package 1A – Concourse Renovations**  
**Proposal Form**

Legal Name of Proposer (Trade Contractor): \_\_\_\_\_

\_\_\_\_\_ Trade Contractor's License Number: \_\_\_\_\_  
*STATE*

Please indicate inclusion/completion of the following items by placing an "X" next to each of the items:

\_\_\_\_\_ Our company has completed a CLARK Subcontractor Qualification Application (SQA) within the past 12 months.

\_\_\_\_\_ Our company has attached a bondability letter from our surety confirming that we will be able to obtain performance and payment bonds from a surety acceptable to CLARK immediately upon subcontract award for the bid amount listed below.

\_\_\_\_\_ Our company has attached a letter from our insurance company confirming that we will be able to procure insurance coverage as listed in CLARK's Exhibit E immediately upon subcontract award for the bid amount listed below.

\_\_\_\_\_ Our company has attached an executed PLA Letter of Assent.

\_\_\_\_\_ Our Company understands that the documents listed below are contract documents, and are the documents that will eventually be converted into a subcontract to the successful proposer. Please initial that you have reviewed the following documents:

\_\_\_\_\_ CLARK's Standard Subcontract Agreement

\_\_\_\_\_ Exhibit A – Contract Documents

\_\_\_\_\_ Exhibit B – Scope of Work

\_\_\_\_\_ Exhibit C – Performance and Payment Bond Forms

\_\_\_\_\_ Exhibit D – General Project Requirements

\_\_\_\_\_ Exhibit D-1 – PLA Letter of Assent

\_\_\_\_\_ Exhibit E – Insurance Requirements

\_\_\_\_\_ Exhibit J – Mandatory Flow Down Provisions

\_\_\_\_\_ Exhibit R – Release Forms



**Proposed SCS Business Participation % included In Proposal:** \_\_\_\_\_ %

**Proposed SBE Business Participation % Included in Proposal:** \_\_\_\_\_ %

SCS/SBE Subcontractors/Suppliers with who participation will be achieved:

1) \_\_\_\_\_

2) \_\_\_\_\_

3) \_\_\_\_\_

*(Note: Provide additional pages as may be required and include appropriate requested certifications. Additionally ensure that you have available for review if requested the outreach efforts conducted in association with providing SCS / SBE participation for this Trade Package)*

Base Bid Proposal Amount for Trade Package 1A = \$ \_\_\_\_\_

Alternates: *Not Applicable*

**Total Proposal Amount: \$** \_\_\_\_\_

*(Note: Inclusive of all alternates and allowances)*

This Proposal amount is inclusive of all cost for the requested Trade Package 1A scope delivery, including but not limited to Payment and Performance Bond premiums, insurances and any applicable taxes or fees.

We have received and acknowledge that the following Addenda are part of the Proposal:

\_\_\_\_\_ Addenda \_\_\_\_\_ Dated: \_\_\_\_\_

\_\_\_\_\_ Addenda \_\_\_\_\_ Dated: \_\_\_\_\_

Name of individual that is authorized to sign subcontracts on behalf of Proposing Company:

Name: \_\_\_\_\_ Title: \_\_\_\_\_



**EXHIBIT B**

Subcontractor shall not proceed with the work of this Subcontract until Clark has received approval of it from the Owner and when Clark has received a notice to proceed from the Owner. Upon occurrence of these conditions precedent, Clark will advise Subcontractor in writing. Subcontractor shall not proceed without written direction from an Officer of Clark to do so.

*EXISTING CONCOURSE RENOVATIONS consists of existing space renovation in several locations around A and B Concourse. These renovations include adjustments to the plumbing, HVAC, electrical systems as well as structural modifications.*

Subcontractor shall furnish to Clark all supervision, materials, labor, equipment, lower-tier subcontracts and all other things necessary for the total and satisfactory execution of all EXISTING CONCOURSE RENOVATIONS on the Project, all in accordance with the Contract Documents listed in Exhibit A and this Subcontract.

The following is a list of the major items of work included in this Subcontract. This list is for clarification only and does not relieve the Subcontractor from accomplishing all EXISTING CONCOURSE RENOVATIONS work complete for the Project, which is the intent of this Subcontract, unless items of work are specifically listed in the "Exclusions" section below.

Furnish and install, complete, all work of the following Specification Sections:

Section 02 41 00	Selective Site Demolition
Section 02 41 19	Removal and Alterations
Section 03 30 00	Cast in Place Concrete
Section 04 22 00	Concrete Masonry Unit
Section 05 12 00	Structural Steel
Section 05 40 00	Cold-Formed Metal Framing
Section 05 50 00	Metal Fabrications
Section 05 52 13	Steel Pipe Handrails and Railings
Section 06 05 00	Lumber and Timber
Section 06 07 10	Fire-Retardant Treated Lumber
Section 06 10 00	Rough Carpentry
Section 06 41 00	Custom Cabinets
Section 07 26 00	Underslab Vapor Barrier
Section 07 84 00	Firestopping
Section 07 92 00	Joint Sealants
Section 08 11 00	Steel Doors and Frames
Section 08 30 00	Specialty Doors
Section 08 31 00	Plastic Laminate Faced Access Panels
Section 08 70 00	Hardware
Section 08 80 00	Glazing
Section 09 20 00	Gypsum Board
Section 09 31 13	Ceramic Tile



**EXHIBIT B**

Section 09 51 00	Acoustical Ceilings
Section 09 65 00	Resilient Flooring
Section 09 65 13	Resilient Wall Base
Section 09 68 00	Carpeting
Section 09 81 00	Acoustical Insulation
Section 09 90 00	Paints and Coatings
Section 10 11 00	Miscellaneous Specialties
Section 10 45 00	Signage
Section 10 26 13	Wall Guards
Section 10 28 13	Toilet Accessories
Section 10 44 13	Fire Extinguisher Cabinets
Section 20 00 00	Mechanical Work – General
Section 20 05 16	Piping Expansion Compensation
Section 20 05 29	Hangers and Supports
Section 20 05 48	Mechanical Sound, Vibration, and Seismic Control
Section 20 05 53	Mechanical Identification
Section 20 07 00	Mechanical Insulation
Section 20 21 16	Piping Specialties
Section 21 10 00	Basic Fire Suppression Materials and Methods
Section 21 13 13	Wet Pipe Fire Suppression Sprinklers
Section 22 11 16	Domestic Water Piping
Section 22 13 16	Sanitary Waste and Vent Piping
Section 22 40 00	Plumbing Fixtures
Section 23 05 93	Testing Adjusting and Balancing
Section 23 09 23	Direct Digital Controls
Section 23 20 00	Heating and Cooling Piping
Section 23 31 00	Ducts
Section 23 34 00	Fans
Section 23 81 13	Terminal Heating and Cooling Units
Section 26 00 00	Electrical Work General
Section 26 05 19	Low-Voltage Electrical Power Conductors and Cables
Section 26 05 26	Grounding and Bonding for Electrical System
Section 26 05 33	Raceways and Boxes for Electrical
Section 26 05 43	Underground Ducts and Raceway for Electrical Systems
Section 26 05 44	Sleeves and Sleeve Seals for Electrical Raceways and Cabling
Section 26 05 53	Identification for Electrical Systems
Section 26 09 23	Lighting Control Devices
Section 26 22 00	Low-Voltage Transformers
Section 26 24 16	Panelboards
Section 26 27 26	Wiring Devices
Section 26 28 13	Fuses
Section 26 28 16	Enclosed Switches and Circuit Breakers
Section 26 51 00	Interior Lighting



**EXHIBIT B**

Section 26 56 00	Exterior Lighting
Section 31 00 00	Earthwork
Section 31 11 00	Clearing and Grubbing
Section 32 11 23	Aggregate Base Courses
Section 32 12 10	Tack Coats
Section 32 12 16	Asphalt Paving
Section 32 17 23	Pavement Markings
Section 32 31 13	Chain Link Fencing and Gates

Furnish and install portions of the following Contract Documents as required for the total and satisfactory performance of the **SCOPE OF WORK** of this Subcontract:

**DIVISION 27      Communications**

Subcontractor shall carry out any related work, which may be described in other Specification Sections as necessary to complete this Subcontractor's work, and Subcontractor shall coordinate its work with the work of other subcontractors in accordance with all sections of the Specifications, and all other requirements of the Contract Documents.

For clarification purposes, and without limiting the Subcontractor's responsibility to furnish and install all **EXISTING CONCOURSE RENOVATIONS** work, the following items are examples of scope specifically included in the work of this Subcontract. All items are "furnish and install" unless otherwise noted:

**TRADE SPECIFIC ITEMS:**

1.      Electrical Shop
  - a)    Construction phasing for this area is as noted in Exhibit B1
  - b)    Temporary locker room as noted in Exhibit B2
  - c)    Creation of one (1) masonry opening for tug path including necessary lintels patching.
  - d)    All required demolition including concrete cutting, removal and patching.
  - e)    Demolition existing lockers noted at United Locker Room.
  - f)    Equipment salvage, including personnel lockers, "Lista" lockers, eye wash station, sinks, cabinets, countertops & etc
  - g)    Equipment relocation (see allowance)
  - h)    Concrete ramps
  - i)    Salvage and reinstallation of overhead doors
  - j)    Salvage of existing power operated swing doors as noted
  - k)    Fireproofing repairs as required
  - l)    Chain link "cage" at tool storage
  - m)    Building column protection at Tug Path
  - n)    Timber wall protection at tug path



**EXHIBIT B**

- o) Installation of owner provided modular furniture including power and communications wiring
- p) Reconfiguration of AHU exhaust ductwork as noted on drawing MH2.1.E01
- q) Relocation of sink, deep sink and eye wash station.
- r) Adjustments to existing fire protection, HVAC, lighting, power, fire alarm, security, data & communications
- s) Tug path pavement markings
- t) Refer to Exhibit B3 for exterior wall condition upon completion of this contract.
- u) Lockers noted on A2.01.E01, plan 2 are to be removed by others and thus are Not in Contract.

2. Conveyor Electrical Shop

- a) All required demolition
- b) Sawcut & demolition of concrete slabs to allow for new leveling surface
- c) Rigid insulation fill & concrete slab
- d) Doors, frames & hardware
- e) Drywall partitions including batt insulation, paint, vinyl base, etc
- f) Relocation of existing ductwork
- g) Disconnection, palletizing & storage of recharging stations
- h) Adjustments to existing fire protection, HVAC, lighting, power, fire alarm, security, data & communications
- i) New lighting

3. Loading Dock Relocation

- a) New AOA Fence
- b) Allowance for paving repairs
- c) Electrical service to new compactor locations
- d) Relocation of dumpsters, compactors, and waste grease storage
- e) Demolition as required
- f) Creation of one (1) masonry opening for entry including necessary lintels, saw-cutting and any necessary patching
- g) New doors & frame
- h) Installation of salvaged oversized double doors including power operation hardware
- i) Drywall partition including any required firestopping
- j) Plywood wall protection as noted
- k) Surface mounted dock lifts for compactor access
- l) Exterior lighting as noted



**EXHIBIT B**

- m) Adjustments to existing fire protection, HVAC, lighting, power, fire alarm, security, data & communications
  - n) Relocation of security cameras
  - o) Pavement markings at dock. Including the restripe of the same area in the year 2018.
  - p) Removal of vehicle barriers as noted
  - q) Site work as detailed on drawing CS3.2.E03
4. United Airline Admin Egress Corridor
- a) Demolition as required
  - b) Replacement of existing doors & frames
  - c) Drywall partition including any required firestopping
  - d) Flooring and base
  - e) Adjustments to existing fire protection, HVAC, lighting, power, fire alarm, security, data & communications
5. United Airlines / AirServe Space
- a) Demolition as required
  - b) New interior & exterior doors and frames
  - c) Drywall partition including any required firestopping
  - d) Flooring and base
  - e) Adjustments to existing fire protection, HVAC, lighting, power, fire alarm, security, data & communications

**GENERAL ITEMS:**

1. Engineering and layout for your work from control lines and benchmarks established by others.
2. Hoisting, scaffolding, ladders and rigging, catch platforms, etc., as required for your work.
3. Subcontractor is responsible to coordinate and obtain acceptance of its work by the applicable governing authorities.
4. Coordinate your work with Clark and other subcontractors to ensure timely schedule of the work.
5. Field measure conditions necessary to ensure correct fabrication and installation of materials provided by this Subcontractor.
6. Subcontractor shall coordinate openings required for your work with other trades prior to their work being installed. For sleeved openings in cast-in-place concrete slabs, beams, walls, etc., furnish and install all sleeves as required for your work. Furnish and install all sleeves, hanger inserts, and penetrations required for the Subcontractor's work, in concrete, prior to the scheduled pour. Subcontractor will sign-off on pour card and is responsible for any rebar scanning/core



**EXHIBIT B**

drilling that is required as a result of missed installation or improper coordination. For block-out openings, layout and set boxes furnished by the concrete subcontractor.

7. Cutting, coring, patching and grouting for your work. Cutting, coring of any structural system is to be x-rayed (or similar) and shall be approved by Structural Engineer prior to performing the work.
8. Receive, unload, handle, protect, and assume full care and custody of materials that are furnished by others for installation by this Subcontractor per the agreed upon Schedule.
9. Fire-safe and seal all penetrations resulting from your work.
10. Sealants and caulking as required for your work including, but not limited to fire caulking, sound caulking, and caulking to adjacent materials.
11. Multiple mobilizations as required for your work.
12. Participate in and support the Commissioning effort for the Project as related to your work.
13. Submission of a haul route will be a requirement of this subcontract. Approval of this plan will be required prior to execution of the work.
14. City of SeaTac business license is required and expected to be in place prior to execution of subcontract.
15. Contractor tradesmen parking is allowed on the 8<sup>th</sup> floor, south end of the parking garage (see Logistics Plan). Application for this pass is required.
16. Temporary lighting and power is the responsibility of this subcontractor. Power source (maximum 120 volt, 20 amps) is available at no cost to this subcontractor.

**REVISIONS TO EXHIBIT D**

1. Paragraph 71; This subcontractor will be responsible for any by passed areas. There will not be any comebacks as a result of other trades.
2. Paragraph 75; This subcontractor will be responsible for all clean-up.

**EXCLUSIONS:**

The following items are specifically excluded from the work of this Subcontract:

1. Reinstallation of Charging Stations (by others).

**SCHEDULE:**



**EXHIBIT B**

Time is of the essence in the execution of the work of this Subcontract. Therefore, sufficient labor and materials must be provided at all times to meet Clark's Job Progress Schedule (hereinafter "Schedule"). [If a delay is caused by this Subcontractor,] Subcontractor shall take whatever steps necessary, including additional manpower, equipment, overtime, shifts, etc., at its sole cost and expense, to perform its work in a time frame and sequence to meet the Schedule and the following milestones:

1. Complete submittals shall be furnished within 15 days of the notice to proceed from Clark.
2. Materials and equipment shall be available for delivery and start of installation in accordance with the Schedule, as directed by Clark.
3. Installation shall be completed in accordance with the Schedule.

**ALTERNATES:**

At Clark's option, any of the following alternates may be included in this Subcontract by change order for the stated amount. Subcontractor shall not proceed with any work associated with the following alternates without prior written direction from an Officer of Clark. The stated amounts include all related costs, overhead, profit, bond premiums, and insurance.

1. NOT APPLICABLE

At Owner's option, any of the following alternates may be included in this Subcontract by change order for the stated amount and shall be performed in accordance with the Contract Documents. [The following alternates are contingent upon the Owner's approval.] Subcontractor shall not proceed with any work associated with the following alternates without prior written direction from an Officer of Clark. The stated amounts include all related costs, overhead, profit, bond premiums, and insurance.

2. NOT APPLICABLE

**UNIT PRICES:**

The following unit prices are included in accordance with the Contract Documents. [The following unit prices are contingent upon the Owner's approval.] Subcontractor shall not proceed with any work associated with the following unit prices without prior written direction from an Officer of Clark. The stated amounts include all related costs, overhead, profit, bond premiums, and insurance.

Description of work	Add Amount (\$)	Deduct Amount (\$)
Labor to move equipment and/or furnishings, per man per hour (standard working hours)		





**EXHIBIT B**

Labor to move equipment and/or furnishings, per man per hour (overtime working hours)		
Labor to move equipment and/or furnishings, per man per hour (double time working hours)		

**ALLOWANCES:**

The following allowances are included in the amount of this Subcontract. Subcontractor shall not proceed with any work associated with these allowances without prior written direction from an Officer of Clark. Work tickets shall be verified daily by Clark’s Superintendent.

1. TWELVE THOUSAND DOLLARS (\$12,000.00) for Equipment and/or Furnishings Relocation and Handling.
2. TWELVE THOUSAND DOLLARS (\$12,000.00) for Paving Repairs at Temporary Loading Dock.
3. TWO THOUSAND DOLLARS (\$2,000) for Providing Electromagnetic Lock at Communications Room #3032 on Drawing A2.2.E02.

**OTHER PROVISIONS:**

1. Drawing references above are for clarification only and are not intended to limit the quantity or location of the work included in this Subcontract or required by the Contract Documents.
2. It is the intent of this Subcontract that the work performed pursuant hereto be complete and acceptable in every respect. The descriptions of the work included herein are clarifications of specific items and are not intended to limit scope of work required and reasonably inferable for complete systems in accordance with the Contract Documents. This Subcontract includes the cost to perform all work necessary to provide a complete and usable facility in accordance with the scope of this Subcontract and the intent of the Contract Documents whether or not all items are explicitly shown or indicated in the Contract Documents at this time.
3. Subcontractor shall provide evidence of Professional Liability Insurance as outlined in the Exhibit E.
3. CLARK is committed to creating contracting opportunities for SCS and SBE businesses, along with employment opportunities for businesses and individuals that live in the local community. While this Project includes an overall contract goal of **12% Small Contractor Supplier (SCS) Certified and 17.5% SBE (SCS/MBE/WBE/DBE/DVBE)**. In an effort to support these goals SCS and SBE has been included as a component of the best value delivery for this scope of work.



Sea-Tac International Arrivals Facility  
Existing Concourse Renovations – Trade Package 1A  
**SUBCONTRACTOR NAME**  
Preliminary Date

**EXHIBIT B**

**(END OF EXHIBIT B)**



**Seattle-Tacoma International Airport  
International Arrivals Facility Project**

MC-0318087 / WP# U00059

**Request for Proposal**

**Trade Package 1B – North East Ground  
Transportation Lot**

ATTACHMENT 1

**SEA TAC IAF**  
**Trade Package 1B – Northeast Ground Transportation Lot**  
**Proposal Form**

Legal Name of Proposer (Trade Contractor): \_\_\_\_\_

\_\_\_\_\_ Trade Contractor's License Number: \_\_\_\_\_  
*STATE*

Please indicate inclusion/completion of the following items by placing an "X" next to each of the items:

\_\_\_\_\_ Our company has completed a CLARK Subcontractor Qualification Application (SQA) within the past 12 months.

\_\_\_\_\_ Our company has attached a bondability letter from our surety confirming that we will be able to obtain performance and payment bonds from a surety acceptable to CLARK immediately upon subcontract award for the bid amount listed below.

\_\_\_\_\_ Our company has attached a letter from our insurance company confirming that we will be able to procure insurance coverage as listed in CLARK's Exhibit E immediately upon subcontract award for the bid amount listed below.

\_\_\_\_\_ Our company has attached an executed PLA Letter of Assent.

\_\_\_\_\_ Our Company understands that the documents listed below are contract documents, and are the documents that will eventually be converted into a subcontract to the successful proposer. Please initial that you have reviewed the following documents:

- \_\_\_\_\_ CLARK's Standard Subcontract Agreement
- \_\_\_\_\_ Exhibit A – Contract Documents
- \_\_\_\_\_ Exhibit B – Scope of Work
- \_\_\_\_\_ Exhibit C – Performance and Payment Bond Forms
- \_\_\_\_\_ Exhibit D – General Project Requirements
- \_\_\_\_\_ Exhibit D-1 – PLA Letter of Assent
- \_\_\_\_\_ Exhibit E – Insurance Requirements
- \_\_\_\_\_ Exhibit J – Mandatory Flow Down Provisions
- \_\_\_\_\_ Exhibit R – Release Forms

**Proposed SCS Business Participation % included In Proposal:** \_\_\_\_\_ %

**Proposed SBE Business Participation % Included in Proposal:** \_\_\_\_\_ %

SCS/SBE Subcontractors/Suppliers with who participation will be achieved:

1) \_\_\_\_\_

2) \_\_\_\_\_

3) \_\_\_\_\_

*(Note: Provide additional pages as may be required and include appropriate requested certifications. Additionally ensure that you have available for review if requested the outreach efforts conducted in association with providing SCS / SBE participation for this Trade Package)*

Base Bid Proposal Amount for Trade Package 1B = \$ \_\_\_\_\_

Alternates: *Not Applicable*

**Total Proposal Amount: \$** \_\_\_\_\_

*(Note: Inclusive of all alternates and allowances)*

This Proposal amount is inclusive of all cost for the requested Trade Package 1B scope delivery, including but not limited to Payment and Performance Bond premiums, insurances and any applicable taxes or fees.

We have received and acknowledge that the following Addenda are part of the Proposal:

\_\_\_\_\_ Addenda \_\_\_\_\_ Dated: \_\_\_\_\_

\_\_\_\_\_ Addenda \_\_\_\_\_ Dated: \_\_\_\_\_

Name of individual that is authorized to sign subcontracts on behalf of Proposing Company:

Name: \_\_\_\_\_ Title: \_\_\_\_\_



**EXHIBIT B**

Subcontractor shall not proceed with the work of this Subcontract until Clark has received approval of it from the Owner and when Clark has received a notice to proceed from the Owner. Upon occurrence of these conditions precedent, Clark will advise Subcontractor in writing. Subcontractor shall not proceed without written direction from an Officer of Clark to do so.

*NORTHEAST GROUND TRANSPORTATION LOT consists of existing asphalt and concrete pavement removals, demolition of concrete and ecology retaining walls, adjustments of existing utility structures, relocation of existing fire hydrant, new asphalt pavement, architectural screening of remediation equipment, new site lighting and landscaping restoration.*

Subcontractor shall furnish to Clark all supervision, materials, labor, equipment, lower-tier subcontracts and all other things necessary for the total and satisfactory execution of all NORTHEAST GROUND TRANSPORTATION LOT on the Project, all in accordance with the Contract Documents listed in Exhibit A and this Subcontract.

The following is a list of the major items of work included in this Subcontract. This list is for clarification only and does not relieve the Subcontractor from accomplishing all NORTHEAST GROUND TRANSPORTATION LOT work complete for the Project, which is the intent of this Subcontract, unless items of work are specifically listed in the "Exclusions" section below.

Furnish and install, complete, all work of the following Specification Sections:

	<b>WSDOT Standard Specifications</b>
<b>Section 03 30 00</b>	<b>Cast in Place Concrete (as it pertains to the Remediation System Screen)</b>
<b>Section 05 50 00</b>	<b>Metal Fabrications (as it pertains to the Remediation System Screen)</b>
<b>Section 26 00 00</b>	<b>Electrical Work General</b>
<b>Section 26 05 19</b>	<b>Low-Voltage Electrical Power Conductors and Cables</b>
<b>Section 26 05 26</b>	<b>Grounding and Bonding for Electrical System</b>
<b>Section 26 05 33</b>	<b>Raceways and Boxes for Electrical</b>
<b>Section 26 05 44</b>	<b>Sleeves and Sleeve Seals for Electrical Raceways and Cabling</b>
<b>Section 26 05 53</b>	<b>Identification for Electrical Systems</b>
<b>Section 26 09 23</b>	<b>Lighting Control Devices</b>
<b>Section 26 24 16</b>	<b>Panelboards</b>
<b>Section 26 27 26</b>	<b>Wiring Devices</b>
<b>Section 26 28 13</b>	<b>Fuses</b>
<b>Section 26 28 16</b>	<b>Enclosed Switches and Circuit Breakers</b>
<b>Section 32 31 13</b>	<b>Chain Link Fencing and Gates (as it pertains to the Remediation System Screen)</b>

Furnish and install portions of the following Contract Documents as required for the total and satisfactory performance of the NORTHEAST GT LOT CIVIL work of this Subcontract:

**DIVISION 27                      Communications**



**EXHIBIT B**

Subcontractor shall carry out any related work, which may be described in other Specification Sections as necessary to complete this Subcontractor's work, and Subcontractor shall coordinate its work with the work of other subcontractors in accordance with all sections of the Specifications, and all other requirements of the Contract Documents.

For clarification purposes, and without limiting the Subcontractor's responsibility to furnish and install all NORTHEAST GT LOT CIVIL work, the following items are examples of scope specifically included in the work of this Subcontract. All items are "furnish and install" unless otherwise noted:

**TRADE SPECIFIC ITEMS:**

1. Existing asphalt and concrete demolition, removal and or reutilization as approved by Clark
2. Demolition of existing bollards and traffic gates as noted
3. Remove existing light poles and bases
4. Landscaping removals as required for new exit drive
5. Ecology block and retaining wall removals as noted
6. Adjustment to existing structure inlet/rim elevations as required
7. Survey and protection of existing methane monitor and collection system
8. Relocation of existing fire hydrant and new protection bollards
9. New curb and paving work
10. Screen wall at remediation collection system as detailed
11. Signage
12. Site lighting including bases, circuitry, trenching and backfill
13. Reconfiguration of existing loop to allow for bus traffic as detailed.
14. Below grade conduit pathways including excavation and backfill associated with communications system including pull string. This item will be coordinated with Trade Package 1E for connection and routing requirements and inspected by Clark Construction Group.
15. This contractor is to include all excavation operations as assumed clean soils. Should restricted soils be discovered, the unit price below will be used for adjustment of contract amount.

**GENERAL ITEMS:**

1. Engineering and layout for your work from control lines and benchmarks established by others.
2. Hoisting, scaffolding, ladders and rigging, catch platforms, etc., as required for your work.
3. Subcontractor is responsible to coordinate and obtain acceptance of its work by the applicable governing authorities.
4. Coordinate your work with Clark and other subcontractors to ensure timely schedule of the work.



**EXHIBIT B**

5. Field measure conditions necessary to ensure correct fabrication and installation of materials provided by this Subcontractor.
6. Subcontractor shall coordinate openings required for your work with other trades prior to their work being installed. For sleeved openings in cast-in-place concrete slabs, beams, walls, etc., furnish and install all sleeves as required for your work. Furnish and install all sleeves, hanger inserts, and penetrations required for the Subcontractor's work, in concrete, prior to the scheduled pour. Subcontractor will sign-off on pour card and is responsible for any rebar scanning/core drilling that is required as a result of missed installation or improper coordination. For block-out openings, layout and set boxes furnished by the concrete subcontractor.
7. Cutting, coring, patching and grouting for your work. Cutting, coring of any structural system is to be x-rayed (or similar) and shall be approved by Structural Engineer prior to performing the work.
8. Receive, unload, handle, protect, and assume full care and custody of materials that are furnished by others for installation by this Subcontractor per the agreed upon Schedule.
9. Fire-safe and seal all penetrations resulting from your work.
10. Sealants and caulking as required for your work including, but not limited to fire caulking, sound caulking, and caulking to adjacent materials.
11. Multiple mobilizations as required for your work.
12. Participate in and support the Commissioning effort for the Project as related to your work.
13. Submission of a haul route will be a requirement of this subcontract. Approval of this plan will be required prior to execution of the work.
14. Traffic control as required.
15. City of SeaTac business license is required and expected to be in place prior to execution of subcontract.
16. Contractor tradesmen parking is allowed on the 8<sup>th</sup> floor, south end of the parking garage (see Logistics Plan). Application for this pass is required.
17. Temporary lighting and power is the responsibility of this subcontractor. Power source (maximum 120 volt, 20 amps) is available at no cost to this subcontractor.

**REVISIONS TO EXHIBIT D**





**EXHIBIT B**

1. Paragraph 71; This subcontractor will be responsible for any by passed areas. There will not be any comebacks as a result of other trades.
2. Paragraph 75; This subcontractor will be responsible for all clean-up. A composite crew approach will not be utilized.

**EXCLUSIONS:**

The following items are specifically excluded from the work of this Subcontract:

1. Communications wiring to gate control. (by Low Voltage – Trade Package 1E subcontractor)
2. Security cameras. (by Low Voltage – Trade Package 1E subcontractor)

**SCHEDULE:**

Time is of the essence in the execution of the work of this Subcontract. Therefore, sufficient labor and materials must be provided at all times to meet Clark's Job Progress Schedule (hereinafter "Schedule"). [If a delay is caused by this Subcontractor,] Subcontractor shall take whatever steps necessary, including additional manpower, equipment, overtime, shifts, etc., at its sole cost and expense, to perform its work in a time frame and sequence to meet the Schedule and the following milestones:

1. Complete submittals shall be furnished within 15 days of the notice to proceed from Clark.
2. Materials and equipment shall be available for delivery and start of installation in accordance with the Schedule, as directed by Clark.
3. Installation shall be completed in accordance with the Schedule.

**ALTERNATES:**

At Clark's option, any of the following alternates may be included in this Subcontract by change order for the stated amount. Subcontractor shall not proceed with any work associated with the following alternates without prior written direction from an Officer of Clark. The stated amounts include all related costs, overhead, profit, bond premiums, and insurance.

1. NOT APPLICABLE

At Owner's option, any of the following alternates may be included in this Subcontract by change order for the stated amount and shall be performed in accordance with the Contract Documents. [The following alternates are contingent upon the Owner's approval.] Subcontractor shall not proceed with any work associated with the following alternates without prior written direction from an Officer of Clark. The stated amounts include all related costs, overhead, profit, bond premiums, and insurance.



**EXHIBIT B**

2. NOT APPLICABLE

**UNIT PRICES:**

The following unit prices are included in accordance with the Contract Documents. [The following unit prices are contingent upon the Owner’s approval.] Subcontractor shall not proceed with any work associated with the following unit prices without prior written direction from an Officer of Clark. The stated amounts include all related costs, overhead, profit, bond premiums, and insurance.

Description of work	Add Amount (\$)	Deduct Amount (\$)
Removal of contaminated soils, per cubic yard (including any additional handling, trucking, fees and disposal)		N/A

**ALLOWANCES:**

The following allowances are included in the amount of this Subcontract. Subcontractor shall not proceed with any work associated with these allowances without prior written direction from an Officer of Clark. Work tickets shall be verified daily by Clark’s Superintendent.

1. NOT APPLICABLE

**OTHER PROVISIONS:**

1. Drawing references above are for clarification only and are not intended to limit the quantity or location of the work included in this Subcontract or required by the Contract Documents.
2. It is the intent of this Subcontract that the work performed pursuant hereto be complete and acceptable in every respect. The descriptions of the work included herein are clarifications of specific items and are not intended to limit scope of work required and reasonably inferable for complete systems in accordance with the Contract Documents. This Subcontract includes the cost to perform all work necessary to provide a complete and usable facility in accordance with the scope of this Subcontract and the intent of the Contract Documents whether or not all items are explicitly shown or indicated in the Contract Documents at this time.
3. CLARK is committed to creating contracting opportunities for SCS and SBE businesses, along with employment opportunities for businesses and individuals that live in the local community. While this Project includes an overall contract goal of **12% Small Contractor Supplier (SCS)**



**EXHIBIT B**

**Certified and 17.5% SBE (SCS/MBE/WBE/DBE/DVBE).** In an effort to support these goals SCS and SBE has been included as a component of the best value delivery for this scope of work.

**(END OF EXHIBIT B)**



**Seattle-Tacoma International Airport  
International Arrivals Facility Project**

MC-0318087 / WP# U00059

**Request for Proposal**

**Trade Package 1C – North East Ground  
Transportation Lot  
Support Facilities**

# SEA TAC IAF

## Trade Package 1C – Northeast Ground Transportation Lot Support Facilities

### Proposal Form

Legal Name of Proposer (Trade Contractor): \_\_\_\_\_

\_\_\_\_\_ Trade Contractor's License Number: \_\_\_\_\_  
STATE

Please indicate inclusion/completion of the following items by placing an "X" next to each of the items:

\_\_\_\_\_ Our company has completed a CLARK Subcontractor Qualification Application (SQA) within the past 12 months.

\_\_\_\_\_ Our company has attached a bondability letter from our surety confirming that we will be able to obtain performance and payment bonds from a surety acceptable to CLARK immediately upon subcontract award for the bid amount listed below.

\_\_\_\_\_ Our company has attached a letter from our insurance company confirming that we will be able to procure insurance coverage as listed in CLARK's Exhibit E immediately upon subcontract award for the bid amount listed below.

\_\_\_\_\_ Our company has attached an executed PLA Letter of Assent.

\_\_\_\_\_ Our Company understands that the documents listed below are contract documents, and are the documents that will eventually be converted into a subcontract to the successful proposer. Please initial that you have reviewed the following documents:

- \_\_\_\_\_ CLARK's Standard Subcontract Agreement
- \_\_\_\_\_ Exhibit A – Contract Documents
- \_\_\_\_\_ Exhibit B – Scope of Work
- \_\_\_\_\_ Exhibit C – Performance and Payment Bond Forms
- \_\_\_\_\_ Exhibit D – General Project Requirements
- \_\_\_\_\_ Exhibit D-1 – PLA Letter of Assent
- \_\_\_\_\_ Exhibit E – Insurance Requirements
- \_\_\_\_\_ Exhibit J – Mandatory Flow Down Provisions
- \_\_\_\_\_ Exhibit R – Release Forms

Proposed SCS Business Participation % included In Proposal: \_\_\_\_\_%

Proposed SBE Business Participation % Included in Proposal: \_\_\_\_\_%

SCS/SBE Subcontractors/Suppliers with who participation will be achieved:

1) \_\_\_\_\_

2) \_\_\_\_\_

3) \_\_\_\_\_

*(Note: Provide additional pages as may be required and include appropriate requested certifications. Additionally ensure that you have available for review if requested the outreach efforts conducted in association with providing SCS / SBE participation for this Trade Package)*

Base Bid Proposal Amount for Trade Package 1C = \$ \_\_\_\_\_

Alternates:

- 1. Add all work at the Parking Garage Third Floor associated with Ground Transportation

[ADD] [DEDUCT] \$ \_\_\_\_\_.

**Total Proposal Amount: \$** \_\_\_\_\_

*(Note: Inclusive of all alternates and allowances)*

This Proposal amount is inclusive of all cost for the requested Trade Package 1C scope delivery, including but not limited to Payment and Performance Bond premiums, insurances and any applicable taxes or fees.

We have received and acknowledge that the following Addenda are part of the Proposal:

\_\_\_\_\_ Addenda \_\_\_\_\_ Dated: \_\_\_\_\_

\_\_\_\_\_ Addenda \_\_\_\_\_ Dated: \_\_\_\_\_

Name of individual that is authorized to sign subcontracts on behalf of Proposing Company:

Name: \_\_\_\_\_ Title: \_\_\_\_\_



**EXHIBIT B**

Subcontractor shall not proceed with the work of this Subcontract until Clark has received approval of it from the Owner and when Clark has received a notice to proceed from the Owner. Upon occurrence of these conditions precedent, Clark will advise Subcontractor in writing. Subcontractor shall not proceed without written direction from an Officer of Clark to do so.

*NORTHEAST GROUND TRANSPORTATION LOT SUPPORT FACILITIES consists a light remodel of the existing first floor office space within the parking garage. Also included is the construction of wayfinding divider screen wall.*

Subcontractor shall furnish to Clark all supervision, materials, labor, equipment, lower-tier subcontracts and all other things necessary for the total and satisfactory execution of all NORTHEAST GROUND TRANSPORTATION LOT SUPPORT FACILITIES on the Project, all in accordance with the Contract Documents listed in Exhibit A and this Subcontract.

The following is a list of the major items of work included in this Subcontract. This list is for clarification only and does not relieve the Subcontractor from accomplishing all NORTHEAST GROUND TRANSPORTATION LOT SUPPORT FACILITIES work complete for the Project, which is the intent of this Subcontract, unless items of work are specifically listed in the "Exclusions" section below.

Furnish and install, complete, all work of the following Specification Sections:

<b>Section 02 41 19</b>	<b>Removal and Alterations</b>
<b>Section 03 30 00</b>	<b>Cast in Place Concrete</b>
<b>Section 04 22 00</b>	<b>Concrete Masonry Unit</b>
<b>Section 05 12 00</b>	<b>Structural Steel</b>
<b>Section 05 40 00</b>	<b>Cold-Formed Metal Framing</b>
<b>Section 05 50 00</b>	<b>Metal Fabrications</b>
<b>Section 05 52 13</b>	<b>Steel Pipe Handrails and Railings</b>
<b>Section 06 05 00</b>	<b>Lumber and Timber</b>
<b>Section 06 07 10</b>	<b>Fire-Retardant Treated Lumber</b>
<b>Section 06 10 00</b>	<b>Rough Carpentry</b>
<b>Section 06 41 00</b>	<b>Custom Cabinets</b>
<b>Section 07 26 00</b>	<b>Underslab Vapor Retarder</b>
<b>Section 07 84 00</b>	<b>Firestopping</b>
<b>Section 07 92 00</b>	<b>Joint Sealants</b>
<b>Section 08 11 00</b>	<b>Steel Doors and Frames</b>
<b>Section 08 30 00</b>	<b>Specialty Doors</b>
<b>Section 08 31 00</b>	<b>Plastic Laminate Faced Access Panels</b>
<b>Section 08 35 13</b>	<b>Sliding Accordion Doors</b>
<b>Section 08 42 29</b>	<b>Sliding Automatic Doors</b>
<b>Section 08 70 00</b>	<b>Hardware</b>
<b>Section 08 80 00</b>	<b>Glazing</b>



**EXHIBIT B**

Section 09 20 00	Gypsum Board
Section 09 31 13	Ceramic Tile
Section 09 51 00	Acoustical Ceilings
Section 09 65 00	Resilient Flooring
Section 09 65 13	Resilient Wall Base
Section 09 68 00	Carpeting
Section 09 81 00	Acoustical Insulation
Section 09 90 00	Paints and Coatings
Section 10 11 00	Miscellaneous Specialties
Section 10 45 00	Signage
Section 10 26 00	Wall Guards
Section 10 28 13	Toilet Accessories
Section 10 44 13	Fire Extinguisher Cabinets
Section 20 00 00	Mechanical Work – General
Section 20 05 16	Piping Expansion Compensation
Section 20 05 29	Hangers and Supports
Section 20 05 48	Mechanical Sound, Vibration, and Seismic Control
Section 20 05 53	Mechanical Identification
Section 20 07 00	Mechanical Insulation
Section 20 21 16	Piping Specialties
Section 21 10 00	Basic Fire Suppression Materials and Methods
Section 21 13 13	Wet Pipe Fire Suppression Sprinklers
Section 22 11 16	Domestic Water Piping
Section 22 13 16	Sanitary Waste and Vent Piping
Section 22 40 00	Plumbing Fixtures
Section 23 05 93	Testing Adjusting and Balancing
Section 23 09 23	Direct Digital Controls
Section 23 20 00	Heating and Cooling Piping
Section 23 31 00	Ducts
Section 23 33 00	Duct Accessories
Section 23 34 00	Fans
Section 23 81 13	Terminal Heating and Cooling Units
Section 26 00 00	Electrical Work General
Section 26 05 19	Low-Voltage Electrical Power Conductors and Cables
Section 26 05 26	Grounding and Bonding for Electrical System
Section 26 05 33	Raceways and Boxes for Electrical
Section 26 05 43	Underground Ducts and Raceways for Electrical Systems
Section 26 05 44	Sleeves and Sleeve Seals for Electrical Raceways and Cabling
Section 26 05 53	Identification for Electrical Systems
Section 26 09 23	Lighting Control Devices
Section 26 22 00	Low-Voltage Transformers
Section 26 24 16	Panelboards
Section 26 27 26	Wiring Devices





**EXHIBIT B**

<b>Section 26 28 13</b>	<b>Fuses</b>
<b>Section 26 28 16</b>	<b>Enclosed Switches and Circuit Breakers</b>
<b>Section 26 51 00</b>	<b>Interior Lighting</b>
<b>Section 26 56 00</b>	<b>Exterior Lighting</b>

Furnish and install portions of the following Contract Documents as required for the total and satisfactory performance of the NORTHEAST GT LOT SUPPORT FACILITIES work of this Subcontract:

**DIVISION 27            Communications**

Subcontractor shall carry out any related work, which may be described in other Specification Sections as necessary to complete this Subcontractor's work, and Subcontractor shall coordinate its work with the work of other subcontractors in accordance with all sections of the Specifications, and all other requirements of the Contract Documents.

For clarification purposes, and without limiting the Subcontractor's responsibility to furnish and install all NORTHEAST GT LOT SUPPORT FACILITIES work, the following items are examples of scope specifically included in the work of this Subcontract. All items are "furnish and install" unless otherwise noted:

**TRADE SPECIFIC ITEMS:**

1. New automatic sliding doors
2. Refresh of existing bathroom facilities
3. Replace transaction counter at existing knee wall
4. Construction of new communications room
5. New wayfinding/walkway screen including lighting, painting and relocation of existing barriers
6. Relocation of kiosks and schedule information displays from GMLH to new locations
7. Re-lamping of existing fluorescent fixtures as detailed
8. Crosswalk warning signs and stripping
9. Relocation of existing benches from South Ground Transportation Lot to new walkway
10. Relocation of vehicle barriers as well as handling and installation of Port supplied barriers

**GENERAL ITEMS:**

1. Engineering and layout for your work from control lines and benchmarks established by others.
2. Hoisting, scaffolding, ladders and rigging, catch platforms, etc., as required for your work.
3. Subcontractor is responsible to coordinate and obtain acceptance of its work by the applicable governing authorities.
4. Coordinate your work with Clark and other subcontractors to ensure timely schedule of the work.



**EXHIBIT B**

5. Field measure conditions necessary to ensure correct fabrication and installation of materials provided by this Subcontractor.
6. Subcontractor shall coordinate openings required for your work with other trades prior to their work being installed. For sleeved openings in cast-in-place concrete slabs, beams, walls, etc., furnish and install all sleeves as required for your work. Furnish and install all sleeves, hanger inserts, and penetrations required for the Subcontractor's work, in concrete, prior to the scheduled pour. Subcontractor will sign-off on pour card and is responsible for any rebar scanning/core drilling that is required as a result of missed installation or improper coordination. For block-out openings, layout and set boxes furnished by the concrete subcontractor.
7. Cutting, coring, patching and grouting for your work. Cutting, coring of any structural system is to be x-rayed (or similar) and shall be approved by Structural Engineer prior to performing the work. Survey and investigation is required for any attachment to the existing parking garage structure.
8. Receive, unload, handle, protect, and assume full care and custody of materials that are furnished by others for installation by this Subcontractor per the agreed upon Schedule.
9. Fire-safe and seal all penetrations resulting from your work.
10. Sealants and caulking as required for your work including, but not limited to fire caulking, sound caulking, and caulking to adjacent materials.
11. Multiple mobilizations as required for your work.
12. Participate in and support the Commissioning effort for the Project as related to your work.
13. Submission of a haul route will be a requirement of this subcontract. Approval of this plan will be required prior to execution of the work.
14. It is specifically noted that this work is within a parking facility that operates 24 hours per day, 365 days per year. Coordination and adherence to the work limit lines is required. Pedestrian safe passage as well as vehicle access must be maintained.
15. City of SeaTac business license is required and expected to be in place prior to execution of subcontract.
16. Contractor tradesmen parking is allowed on the 8<sup>th</sup> floor, south end of the parking garage. Application for this pass is required.
17. Temporary lighting and power is the responsibility of this subcontractor. Power source (maximum 120 volt, 20 amps) is available at no cost to this subcontractor.



**EXHIBIT B**

**REVISIONS TO EXHIBIT D**

1. Paragraph 71; This subcontractor will be responsible for any by passed areas. There will not be any comebacks as a result of other trades.
2. Paragraph 75; This subcontractor will be responsible for all clean-up.

**EXCLUSIONS:**

The following items are specifically excluded from the work of this Subcontract:

1. NOT APPLICABLE

**SCHEDULE:**

Time is of the essence in the execution of the work of this Subcontract. Therefore, sufficient labor and materials must be provided at all times to meet Clark's Job Progress Schedule (hereinafter "Schedule"). [If a delay is caused by this Subcontractor,] Subcontractor shall take whatever steps necessary, including additional manpower, equipment, overtime, shifts, etc., at its sole cost and expense, to perform its work in a time frame and sequence to meet the Schedule and the following milestones:

1. Complete submittals shall be furnished within 15 days of the notice to proceed from Clark.
2. Materials and equipment shall be available for delivery and start of installation in accordance with the Schedule, as directed by Clark.
3. Installation shall be completed in accordance with the Schedule.

**ALTERNATES:**

At Clark's option, any of the following alternates may be included in this Subcontract by change order for the stated amount. Subcontractor shall not proceed with any work associated with the following alternates without prior written direction from an Officer of Clark. The stated amounts include all related costs, overhead, profit, bond premiums, and insurance.

1. NOT APPLICABLE

At Owner's option, any of the following alternates may be included in this Subcontract by change order for the stated amount and shall be performed in accordance with the Contract Documents. [The following alternates are contingent upon the Owner's approval.] Subcontractor shall not proceed with any work associated with the following alternates without prior written direction from an Officer of Clark. The stated amounts include all related costs, overhead, profit, bond premiums, and insurance.



**EXHIBIT B**

2. ADD ALL WORK AT THE PARKING GARAGE THIRD FLOOR ASSOCIATED WITH GROUND TRANSPORTATION. [ADD] [DEDUCT] \_\_\_\_\_ DOLLARS (\$00.00).

**UNIT PRICES:**

The following unit prices are included in accordance with the Contract Documents. [The following unit prices are contingent upon the Owner’s approval.] Subcontractor shall not proceed with any work associated with the following unit prices without prior written direction from an Officer of Clark. The stated amounts include all related costs, overhead, profit, bond premiums, and insurance.

Description of work	Add Amount (\$)	Deduct Amount (\$)
Screen wall, all-inclusive, per lineal foot (excluding lights, fire extinguishers, code blue stations)		
Screen wall light fixture, including 10’ of associated conduit & wire, per each		
Concrete patching to meet ADA, per square foot		

**ALLOWANCES:**

The following allowances are included in the amount of this Subcontract. Subcontractor shall not proceed with any work associated with these allowances without prior written direction from an Officer of Clark. Work tickets shall be verified daily by Clark’s Superintendent.

1. TEN THOUSAND DOLLARS (\$10,000.00) for Wayfinding Signage.
2. FIVE THOUSAND DOLLARS (\$5,000.00) for Concrete Patching.
3. FIFTY THOUSAND DOLLARS (\$50,000) for Architectural as well as Heating and Cooling of POS Communications Room. Including associated temperature controls and electric circuitry.
4. FOURTY THOUSAND DOLLARS (\$40,000) for Interior Seating at 1<sup>st</sup> Floor Waiting Area #105.

**OTHER PROVISIONS:**

1. Drawing references above are for clarification only and are not intended to limit the quantity or location of the work included in this Subcontract or required by the Contract Documents.
2. It is the intent of this Subcontract that the work performed pursuant hereto be complete and acceptable in every respect. The descriptions of the work included herein are clarifications of



**EXHIBIT B**

specific items and are not intended to limit scope of work required and reasonably inferable for complete systems in accordance with the Contract Documents. This Subcontract includes the cost to perform all work necessary to provide a complete and usable facility in accordance with the scope of this Subcontract and the intent of the Contract Documents whether or not all items are explicitly shown or indicated in the Contract Documents at this time.

3. CLARK is committed to creating contracting opportunities for SCS and SBE businesses, along with employment opportunities for businesses and individuals that live in the local community. While this Project includes an overall contract goal of **12% Small Contractor Supplier (SCS) Certified and 17.5% SBE (SCS/MBE/WBE/DBE/DVBE)**. In an effort to support these goals SCS and SBE has been included as a component of the best value delivery for this scope of work.

**(END OF EXHIBIT B)**



**Seattle-Tacoma International Airport  
International Arrivals Facility Project  
MC-0318087 / WP# U00059**

**Request for Proposal**

**Trade Package 1D – Maki Sculpture Relocation**

ATTACHMENT 1

**SEA TAC IAF**  
**Trade Package 1D – Maki Sculpture Relocation**  
**Proposal Form**

Legal Name of Proposer (Trade Contractor): \_\_\_\_\_

\_\_\_\_\_ Trade Contractor's License Number: \_\_\_\_\_  
*STATE*

Please indicate inclusion/completion of the following items by placing an "X" next to each of the items:

\_\_\_\_\_ Our company has completed a CLARK Subcontractor Qualification Application (SQA) within the past 12 months.

\_\_\_\_\_ Our company has attached a bondability letter from our surety confirming that we will be able to obtain performance and payment bonds from a surety acceptable to CLARK immediately upon subcontract award for the bid amount listed below.

\_\_\_\_\_ Our company has attached a letter from our insurance company confirming that we will be able to procure insurance coverage as listed in CLARK's Exhibit E immediately upon subcontract award for the bid amount listed below.

\_\_\_\_\_ Our company has attached an executed PLA Letter of Assent.

\_\_\_\_\_ Our Company understands that the documents listed below are contract documents, and are the documents that will eventually be converted into a subcontract to the successful proposer. Please initial that you have reviewed the following documents:

- \_\_\_\_\_ CLARK's Standard Subcontract Agreement
- \_\_\_\_\_ Exhibit A – Contract Documents
- \_\_\_\_\_ Exhibit B – Scope of Work
- \_\_\_\_\_ Exhibit C – Performance and Payment Bond Forms
- \_\_\_\_\_ Exhibit D – General Project Requirements
- \_\_\_\_\_ Exhibit D-1 – PLA Letter of Assent
- \_\_\_\_\_ Exhibit E – Insurance Requirements
- \_\_\_\_\_ Exhibit J – Mandatory Flow Down Provisions
- \_\_\_\_\_ Exhibit R – Release Forms

**Proposed SCS Business Participation % included In Proposal:** \_\_\_\_\_ %

**Proposed SBE Business Participation % Included in Proposal:** \_\_\_\_\_ %

SCS/SBE Subcontractors/Suppliers with who participation will be achieved:

1) \_\_\_\_\_

2) \_\_\_\_\_

3) \_\_\_\_\_

*(Note: Provide additional pages as may be required and include appropriate requested certifications. Additionally ensure that you have available for review if requested the outreach efforts conducted in association with providing SCS / SBE participation for this Trade Package)*

Base Bid Proposal Amount for Trade Package 1D = \$ \_\_\_\_\_

**Total Proposal Amount: \$** \_\_\_\_\_

Alternates:

1. Change light fixtures to option "B" as noted in Exhibit B4. [ADD] [DEDUCT]  
\$ \_\_\_\_\_

2. Change light fixtures to option "C" as noted in Exhibit B4. [ADD] [DEDUCT]  
\$ \_\_\_\_\_

3. Change light fixtures to option "B" as noted in Exhibit B4. [ADD] [DEDUCT]  
\$ \_\_\_\_\_

This Proposal amount is inclusive of all cost for the requested Trade Package 1D scope delivery, including but not limited to Payment and Performance Bond premiums, insurances and any applicable taxes or fees.

We have received and acknowledge that the following Addenda are part of the Proposal:

\_\_\_\_\_ Addenda \_\_\_\_\_ Dated: \_\_\_\_\_

\_\_\_\_\_ Addenda \_\_\_\_\_ Dated: \_\_\_\_\_

Name of individual that is authorized to sign subcontracts on behalf of Proposing Company:

Name: \_\_\_\_\_ Title: \_\_\_\_\_





**EXHIBIT B**

Subcontractor shall not proceed with the work of this Subcontract until Clark has received approval of it from the Owner and when Clark has received a notice to proceed from the Owner. Upon occurrence of these conditions precedent, Clark will advise Subcontractor in writing. Subcontractor shall not proceed without written direction from an Officer of Clark to do so.

*MAKI SCULPTURE RELOCATION consists of new concrete pad, associated earthwork, landscape modifications, irrigation modifications as well as new site lighting.*

Subcontractor shall furnish to Clark all supervision, materials, labor, equipment, lower-tier subcontracts and all other things necessary for the total and satisfactory execution of all MAKI SCULPTURE RELOCATION on the Project, all in accordance with the Contract Documents listed in Exhibit A and this Subcontract.

The following is a list of the major items of work included in this Subcontract. This list is for clarification only and does not relieve the Subcontractor from accomplishing all MAKI SCULPTURE RELOCATION work complete for the Project, which is the intent of this Subcontract, unless items of work are specifically listed in the "Exclusions" section below.

Furnish and install, complete, all work of the following Specification Sections:

<b>Section 02 41 00</b>	<b>Selective Site Demolition</b>
<b>Section 02 41 19</b>	<b>Removal and Alterations</b>
<b>Section 03 30 00</b>	<b>Cast in Place Concrete</b>
<b>Section 05 50 00</b>	<b>Metal Fabrications</b>
<b>Section 26 00 00</b>	<b>Electrical Work General</b>
<b>Section 26 05 19</b>	<b>Low-Voltage Electrical Power Conductors and Cables</b>
<b>Section 26 05 26</b>	<b>Grounding and Bonding for Electrical System</b>
<b>Section 26 05 29</b>	<b>Hanger &amp; Supports for Electrical Systems</b>
<b>Section 26 05 33</b>	<b>Raceways and Boxes for Electrical</b>
<b>Section 26 05 43</b>	<b>Underground Ducts and Raceway for Electrical Systems</b>
<b>Section 26 05 44</b>	<b>Sleeves and Sleeve Seals for Electrical Raceways and Cabling</b>
<b>Section 26 05 53</b>	<b>Identification for Electrical Systems</b>
<b>Section 26 09 23</b>	<b>Lighting Control Devices</b>
<b>Section 26 22 00</b>	<b>Low Voltage Transformers</b>
<b>Section 26 24 16</b>	<b>Panelboards</b>
<b>Section 26 27 26</b>	<b>Wiring Devices</b>
<b>Section 26 28 13</b>	<b>Fuses</b>
<b>Section 26 28 16</b>	<b>Enclosed Switches and Circuit Breakers</b>
<b>Section 26 56 00</b>	<b>Exterior Lighting</b>
<b>Section 31 00 00</b>	<b>Earthwork</b>
<b>Section 31 11 00</b>	<b>Clearing and Grubbing</b>



## **EXHIBIT B**

Furnish and install portions of the following Contract Documents as required for the total and satisfactory performance of the MAKI SCULPTURE RELOCATION work of this Subcontract:

### **DIVISION 1 – GENERAL REQUIREMENTS**

Subcontractor shall carry out any related work, which may be described in other Specification Sections as necessary to complete this Subcontractor's work, and Subcontractor shall coordinate its work with the work of other subcontractors in accordance with all sections of the Specifications, and all other requirements of the Contract Documents.

For clarification purposes, and without limiting the Subcontractor's responsibility to furnish and install all MAKI SCULPTURE RELOCATION work, the following items are examples of scope specifically included in the work of this Subcontract. All items are "furnish and install" unless otherwise noted:

#### **TRADE SPECIFIC ITEMS:**

1. Temporary road, staging, crane paths if/as required
2. Rigging, trucking and relocation of sculpture / art work
3. Concrete foundation at new location
4. Exterior lighting including branch circuits. This will include mock-up of light fixtures during off-hours for approval by the artist. This lighting mock-up will be performed at the existing sculpture location.
5. Landscape re-establishment including modifications to irrigation systems (see exhibit B5). Please note the irrigation system modification design requirements are the responsibility of this contract.

#### **GENERAL ITEMS:**

1. Engineering and layout for your work from control lines and benchmarks established by others.
2. Contractor is hereby notified that this work is for relocation of a sculpture. This item is art work and should be treated as such.
3. Artist scheduling, refinishing, owner interface will be coordinated with Clark.
4. Hoisting, scaffolding, ladders and rigging, catch platforms, etc., as required for your work.
5. Subcontractor is responsible to coordinate and obtain acceptance of its work by the applicable governing authorities.
6. Coordinate your work with Clark and other subcontractors to ensure timely schedule of the work.
7. Field measure conditions necessary to ensure correct fabrication and installation of materials provided by this Subcontractor.



**EXHIBIT B**

8. Subcontractor shall coordinate openings required for your work with other trades prior to their work being installed. For sleeved openings in cast-in-place concrete slabs, beams, walls, etc., Furnish and install all sleeves as required for your work. Furnish and install all sleeves, hanger inserts, and penetrations required for the Subcontractor's work, in concrete, prior to the scheduled pour. Subcontractor will sign-off on pour card and is responsible for any rebar scanning/core drilling that is required as a result of missed installation or improper coordination. For block-out openings, layout and set boxes furnished by the concrete subcontractor.
9. Cutting, coring, patching and grouting for your work. Cutting, coring of any structural system is to be x-rayed (or similar) and shall be approved by Structural Engineer prior to performing the work.
10. Receive, unload, handle, protect, and assume full care and custody of materials that are furnished by others for installation by this Subcontractor per the agreed upon Schedule.
11. Multiple mobilizations as required for your work.
12. Participate in and support the Commissioning effort for the site lighting related to your work.
13. Submission of a haul route will be a requirement of this subcontract. Approval of this plan will be required prior to execution of the work.
14. Coordination of relocation is required with local jurisdictions and Port of Seattle.
15. City of SeaTac business license is required and expected to be in place prior to execution of subcontract.
16. Contractor tradesmen parking is allowed on the 8<sup>th</sup> floor, south end of the parking garage (see Logistics Plan). Application for this pass is required.
17. Temporary lighting and power is the responsibility of this subcontractor. Power source (maximum 120 volt, 20 amps) is available at no cost to this subcontractor.

**REVISIONS TO EXHIBIT D**

1. Paragraph 71; This subcontractor will be responsible for any by passed areas. There will not be any comebacks as a result of other trades.
2. Paragraph 75; This subcontractor will be responsible for all clean-up.

**EXCLUSIONS:**

The following items are specifically excluded from the work of this Subcontract:

1. Refinish of Sculpture. (by owner)



**EXHIBIT B**

2. Demolition of lighting and pad at existing location. (by Site Prep subcontractor)

**SCHEDULE:**

Time is of the essence in the execution of the work of this Subcontract. Therefore, sufficient labor and materials must be provided at all times to meet Clark's Job Progress Schedule (hereinafter "Schedule"). [If a delay is caused by this Subcontractor,] Subcontractor shall take whatever steps necessary, including additional manpower, equipment, overtime, shifts, etc., at its sole cost and expense, to perform its work in a time frame and sequence to meet the Schedule and the following milestones:

1. Complete submittals shall be furnished within 15 days of the notice to proceed from Clark.
2. Materials and equipment shall be available for delivery and start of installation in accordance with the Schedule, as directed by Clark.
3. Installation shall be completed in accordance with the Schedule.

**ALTERNATES:**

At Clark's option, any of the following alternates may be included in this Subcontract by change order for the stated amount. Subcontractor shall not proceed with any work associated with the following alternates without prior written direction from an Officer of Clark. The stated amounts include all related costs, overhead, profit, bond premiums, and insurance.

1. NOT APPLICABLE

At Owner's option, any of the following alternates may be included in this Subcontract by change order for the stated amount and shall be performed in accordance with the Contract Documents. [The following alternates are contingent upon the Owner's approval.] Subcontractor shall not proceed with any work associated with the following alternates without prior written direction from an Officer of Clark. The stated amounts include all related costs, overhead, profit, bond premiums, and insurance.

2. CHANGE LIGHT FIXTURES TO OPTION "B" AS NOTED IN EXHIBIT B4. [ADD] [DEDUCT] \_\_\_\_\_ DOLLARS (\$00.00).
3. CHANGE LIGHT FIXTURES TO OPTION "C" AS NOTED IN EXHIBIT B4. [ADD] [DEDUCT] \_\_\_\_\_ DOLLARS (\$00.00).
4. CHANGE LIGHT FIXTURES TO OPTION "D" AS NOTED IN EXHIBIT B4. [ADD] [DEDUCT] \_\_\_\_\_ DOLLARS (\$00.00).

**UNIT PRICES:**



**EXHIBIT B**

The following unit prices are included in accordance with the Contract Documents. [The following unit prices are contingent upon the Owner’s approval.] Subcontractor shall not proceed with any work associated with the following unit prices without prior written direction from an Officer of Clark. The stated amounts include all related costs, overhead, profit, bond premiums, and insurance.

Description of work	Add Amount (\$)	Deduct Amount (\$)
NOT APPLICABLE		

**ALLOWANCES:**

The following allowances are included in the amount of this Subcontract. Subcontractor shall not proceed with any work associated with these allowances without prior written direction from an Officer of Clark. Work tickets shall be verified daily by Clark’s Superintendent.

1. NOT APPLICABLE

**OTHER PROVISIONS:**

1. Drawing references above are for clarification only and are not intended to limit the quantity or location of the work included in this Subcontract or required by the Contract Documents.
2. It is the intent of this Subcontract that the work performed pursuant hereto be complete and acceptable in every respect. The descriptions of the work included herein are clarifications of specific items and are not intended to limit scope of work required and reasonably inferable for complete systems in accordance with the Contract Documents. This Subcontract includes the cost to perform all work necessary to provide a complete and usable facility in accordance with the scope of this Subcontract and the intent of the Contract Documents whether or not all items are explicitly shown or indicated in the Contract Documents at this time.
3. CLARK is committed to creating contracting opportunities for SCS and SBE businesses, along with employment opportunities for businesses and individuals that live in the local community. While this Project includes an overall contract goal of **12% Small Contractor Supplier (SCS) Certified and 17.5% SBE (SCS/MBE/WBE/DBE/DVBE)**. In an effort to support these goals SCS and SBE has been included as a component of the best value delivery for this scope of work.

**(END OF EXHIBIT B)**



**Seattle-Tacoma International Airport  
International Arrivals Facility Project  
MC-0318087 / WP# U00059**

**Request for Proposal**

**Trade Package 1E – Low Voltage Systems for  
Early Works Projects 1A and 1C**

# SEA TAC IAF

## Trade Package 1E – Low Voltage Systems for Early Works

### Proposal Form

Legal Name of Proposer (Trade Contractor): \_\_\_\_\_

\_\_\_\_\_ Trade Contractor's License Number: \_\_\_\_\_  
STATE

Please indicate inclusion/completion of the following items by placing an "X" next to each of the items:

\_\_\_\_\_ Our company has completed a CLARK Subcontractor Qualification Application (SQA) within the past 12 months.

\_\_\_\_\_ Our company has attached a bondability letter from our surety confirming that we will be able to obtain performance and payment bonds from a surety acceptable to CLARK immediately upon subcontract award for the bid amount listed below.

\_\_\_\_\_ Our company has attached a letter from our insurance company confirming that we will be able to procure insurance coverage as listed in CLARK's Exhibit E immediately upon subcontract award for the bid amount listed below.

\_\_\_\_\_ Our company has attached an executed PLA Letter of Assent.

\_\_\_\_\_ Our Company understands that the documents listed below are contract documents, and are the documents that will eventually be converted into a subcontract to the successful proposer. Please initial that you have reviewed the following documents:

- \_\_\_\_\_ CLARK's Standard Subcontract Agreement
- \_\_\_\_\_ Exhibit A – Contract Documents
- \_\_\_\_\_ Exhibit B – Scope of Work
- \_\_\_\_\_ Exhibit C – Performance and Payment Bond Forms
- \_\_\_\_\_ Exhibit D – General Project Requirements
- \_\_\_\_\_ Exhibit D-1 – PLA Letter of Assent
- \_\_\_\_\_ Exhibit E – Insurance Requirements
- \_\_\_\_\_ Exhibit J – Mandatory Flow Down Provisions
- \_\_\_\_\_ Exhibit R – Release Forms

**Proposed SCS Business Participation % included In Proposal:** \_\_\_\_\_ %

**Proposed SBE Business Participation % Included in Proposal:** \_\_\_\_\_ %

SCS/SBE Subcontractors/Suppliers with who participation will be achieved:

- 1) \_\_\_\_\_
- 2) \_\_\_\_\_
- 3) \_\_\_\_\_

*(Note: Provide additional pages as may be required and include appropriate requested certifications. Additionally ensure that you have available for review if requested the outreach efforts conducted in association with providing SCS / SBE participation for this Trade Package)*

Base Bid Proposal Amount for Trade Package 1E = \$ \_\_\_\_\_

Alternates: *Not Applicable*

**Total Proposal Amount: \$** \_\_\_\_\_

*(Note: In case of conflict - written proposal value will supersede numeric value)*

This Proposal amount is inclusive of all cost for the requested Trade Package 1E scope delivery, including but not limited to Payment and Performance Bond premiums, insurances and any applicable taxes or fees.

We have received and acknowledge that the following Addenda are part of the Proposal:

\_\_\_\_\_ Addenda \_\_\_\_\_ Dated: \_\_\_\_\_

\_\_\_\_\_ Addenda \_\_\_\_\_ Dated: \_\_\_\_\_

Name of individual that is authorized to sign subcontracts on behalf of Proposing Company:

Name: \_\_\_\_\_ Title: \_\_\_\_\_





**EXHIBIT B**

**Subcontractor shall not proceed with the work of this Subcontract until Clark has received approval of it from the Owner and when Clark has received a notice to proceed from the Owner. Upon occurrence of these conditions precedent, Clark will advise Subcontractor in writing. Subcontractor shall not proceed without written direction from an Officer of Clark to do so. [See STANDARD CONTINGENCY CLAUSES file for alternative language, if applicable]**

*LOW VOLTAGE FOR EARLY WORKS consists of reconfiguration of existing systems as required. This also includes the testing, verification and start-up of several systems.*

Subcontractor shall furnish to Clark all supervision, materials, labor, equipment, lower-tier subcontracts and all other things necessary for the total and satisfactory execution of all LOW VOLTAGE FOR EARLY WORKS on the Project, all in accordance with the Contract Documents listed in Exhibit A and this Subcontract.

The following is a list of the major items of work included in this Subcontract. This list is for clarification only and does not relieve the Subcontractor from accomplishing all LOW VOLTAGE FOR EARLY WORKS work complete for the Project, which is the intent of this Subcontract, unless items of work are specifically listed in the "Exclusions" section below.

Furnish and install, complete, all work of the following Specification Sections:

- Section 27 05 13      General Communications Requirements**
- Section 27 05 28      Communications Pathway**
- Section 27 05 53      Identification and Labeling**
- Section 27 05 53\_13    Communications Standard for Labeling and Nomenclature**
- Section 27 05 53\_23    Port of Seattle Color Code Requirements**
- Section 27 08 00      Communications Infrastructure Commissioning**
- Section 27 13 00      Backbone Cabling Requirements**
- Section 27 15 00      Horizontal Cabling**

Furnish and install portions of the following Contract Documents as required for the total and satisfactory performance of the LOW VOLTAGE FOR EARLY WORKS work of this Subcontract:

**DIVISION 1 – GENERAL REQUIREMENTS**

Subcontractor shall carry out any related work, which may be described in other Specification Sections as necessary to complete this Subcontractor’s work, and Subcontractor shall coordinate its work with the work of other subcontractors in accordance with all sections of the Specifications, and all other requirements of the Contract Documents.

For clarification purposes, and without limiting the Subcontractor’s responsibility to furnish and install all LOW VOLTAGE FOR EARLY WORKS work, the following items are examples of scope specifically included in the work of this Subcontract. All items are "furnish and install" unless otherwise noted:



**EXHIBIT B**

**TRADE SPECIFIC ITEMS:**

1. Reconfiguration of security and access control systems including cameras as detailed.
2. Reconfiguration of Wi-Fi system as detailed including coverage verification testing.
3. Reconfiguration of distributed area antenna system as detailed including coverage verification testing.
4. Reconfiguration of terminal wide paging where applicable.
5. Reconfiguration of any GIDS, FIDS and BIDS where applicable.

**GENERAL ITEMS:**

1. Engineering and layout for your work from control lines and benchmarks established by others.
2. Hoisting, scaffolding, ladders and rigging, catch platforms, etc., as required for your work.
3. Subcontractor is responsible to coordinate and obtain acceptance of its work by the applicable governing authorities.
4. Coordinate your work with Clark and other subcontractors to ensure timely schedule of the work.
5. Field measure conditions necessary to ensure correct fabrication and installation of materials provided by this Subcontractor.
6. Subcontractor shall coordinate openings required for your work with other trades prior to their work being installed. For sleeved openings in cast-in-place concrete slabs, beams, walls, etc., furnish and install all sleeves as required for your work. Furnish and install all sleeves, hanger inserts, and penetrations required for the Subcontractor's work, in concrete, prior to the scheduled pour. Subcontractor will sign-off on pour card and is responsible for any rebar scanning/core drilling that is required as a result of missed installation or improper coordination. For block-out openings, layout and set boxes furnished by the concrete subcontractor.
7. Cutting, coring, patching and grouting for your work. Cutting, coring of any structural system is to be x-rayed (or similar) and shall be approved by Structural Engineer prior to performing the work.
8. Receive, unload, handle, protect, and assume full care and custody of materials that are furnished by others for installation by this Subcontractor per the agreed upon Schedule.
9. Fire-safe and seal all penetrations resulting from your work.
10. Multiple mobilizations as required for your work.



**EXHIBIT B**

11. Participate in and support the Commissioning effort for the Project as related to your work.
12. Temporary lighting and power is the responsibility of this subcontractor. Power source (maximum 120 volt, 20 amps) is available at no cost to this subcontractor.

**REVISIONS TO EXHIBIT D**

1. Paragraph 71; This subcontractor will be responsible for any by passed areas. There will not be any comebacks as a result of other trades.
2. Paragraph 75; This subcontractor will be responsible for all clean-up.

**EXCLUSIONS:**

The following items are specifically excluded from the work of this Subcontract:

1. NOT APPLICABLE

**SCHEDULE:**

Time is of the essence in the execution of the work of this Subcontract. Therefore, sufficient labor and materials must be provided at all times to meet Clark's Job Progress Schedule (hereinafter "Schedule"). [If a delay is caused by this Subcontractor,] Subcontractor shall take whatever steps necessary, including additional manpower, equipment, overtime, shifts, etc., at its sole cost and expense, to perform its work in a time frame and sequence to meet the Schedule and the following milestones:

1. Complete submittals shall be furnished within 15 days of the notice to proceed from Clark.
2. Materials and equipment shall be available for delivery and start of installation in accordance with the Schedule, as directed by Clark.
3. Installation shall be completed in accordance with the Schedule.

**ALTERNATES:**

At Clark's option, any of the following alternates may be included in this Subcontract by change order for the stated amount. Subcontractor shall not proceed with any work associated with the following alternates without prior written direction from an Officer of Clark. The stated amounts include all related costs, overhead, profit, bond premiums, and insurance.

1. NOT APPLICABLE

At Owner's option, any of the following alternates may be included in this Subcontract by change order for the stated amount and shall be performed in accordance with the Contract Documents. [The following alternates are contingent upon the Owner's approval.] Subcontractor shall not proceed with



**EXHIBIT B**

any work associated with the following alternates without prior written direction from an Officer of Clark. The stated amounts include all related costs, overhead, profit, bond premiums, and insurance.

1. ADD ALL WORK AT THE PARKING GARAGE THIRD FLOOR ASSOCIATED WITH GROUND TRANSPORTATION. [ADD] [DEDUCT] \_\_\_\_\_ DOLLARS (\$00.00).

**UNIT PRICES:**

The following unit prices are included in accordance with the Contract Documents. [The following unit prices are contingent upon the Owner’s approval.] Subcontractor shall not proceed with any work associated with the following unit prices without prior written direction from an Officer of Clark. The stated amounts include all related costs, overhead, profit, bond premiums, and insurance.

Description of work	Add Amount (\$)	Deduct Amount (\$)
NOT APPLICABLE		

**ALLOWANCES:**

The following allowances are included in the amount of this Subcontract. Subcontractor shall not proceed with any work associated with these allowances without prior written direction from an Officer of Clark. Work tickets shall be verified daily by Clark’s Superintendent.

1. NOT APPLICABLE

**OTHER PROVISIONS:**

1. Drawing references above are for clarification only and are not intended to limit the quantity or location of the work included in this Subcontract or required by the Contract Documents.
2. It is the intent of this Subcontract that the work performed pursuant hereto be complete and acceptable in every respect. The descriptions of the work included herein are clarifications of specific items and are not intended to limit scope of work required and reasonably inferable for complete systems in accordance with the Contract Documents. This Subcontract includes the cost to perform all work necessary to provide a complete and usable facility in accordance with the scope of this Subcontract and the intent of the Contract Documents whether or not all items are explicitly shown or indicated in the Contract Documents at this time.
3. Subcontractor shall provide evidence of Professional Liability Insurance as outlined in the Exhibit E.



**EXHIBIT B**

3. CLARK is committed to creating contracting opportunities for SCS and SBE businesses, along with employment opportunities for businesses and individuals that live in the local community. While this Project includes an overall contract goal of **12% Small Contractor Supplier (SCS) Certified and 17.5% SBE (SCS/MBE/WBE/DBE/DVBE)**. In an effort to support these goals SCS and SBE has been included as a component of the best value delivery for this scope of work.

**(END OF EXHIBIT B)**

New IAF  
Sterile Corridor / Gate Pods  
Pedestrian Bridge



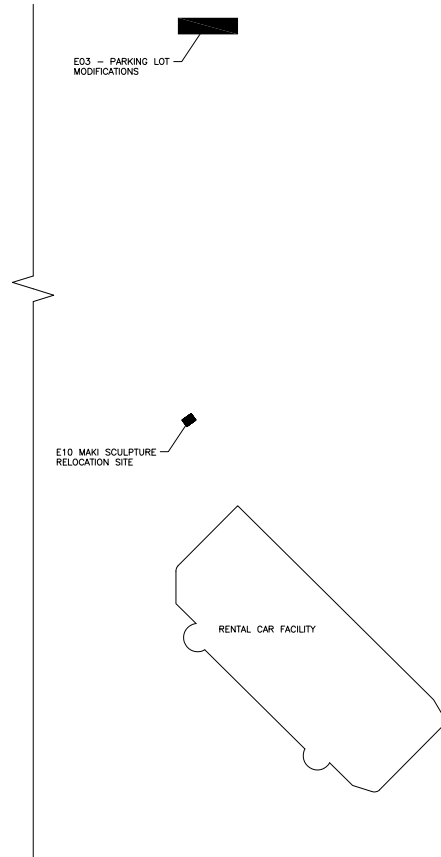
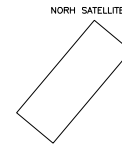
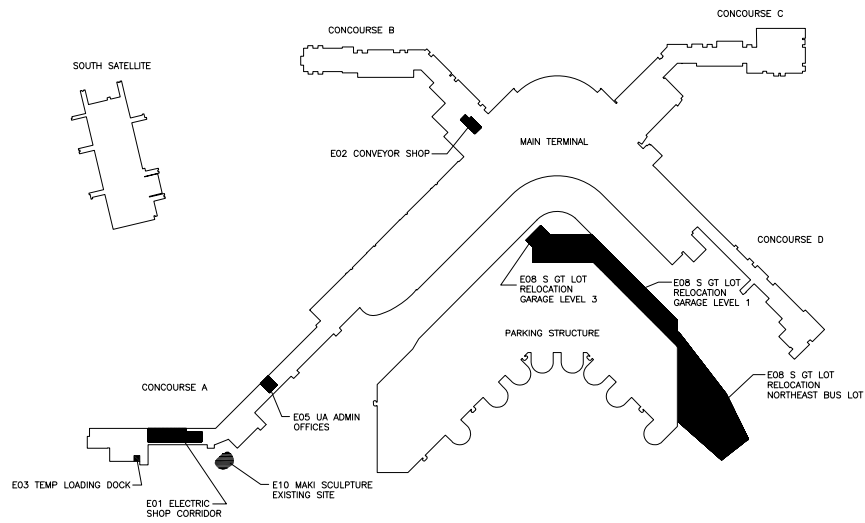

### IAF Trade Contractor Evaluation Criteria

Criteria Evaluated	Metric	Proposal 1 Trade Contractor
Complete Clark SQA Information?	Pass/Fail	
Provided Letter of Bondability?	Pass/Fail	
Provided Letter Confirming Insurance Coverage?	Pass/Fail	
Agreement to Assent to the PLA?	Pass/Fail	
Exceptions Requested to Contract Terms Acceptable?	Pass/Fail	
Total Proposal Amount	As Bid	
SCS Participation Level <i>(must be certified SCS)</i>	Percentage	
SBE Participation Level <i>(Per RFP/Contract requirements)</i>	Percentage	
<b>Contract – Point Scoring Analysis</b>		
Cost Proposal – Points Credited	95	
SCS Participation – Points Credited	3	
SEB Participation – Points Credited	2	
Total Points	100	

**Cost Proposal Credit Calculation**

A = Maximum Points Allocated

B = Lowest Passing Bid

C = B/A

D = Amount Bid

Points Awarded =  $A - (D-B)/C$

Highest Passing Bid Received at Bid Opening     \$     -

Lowest Passing Bid Received at Bid Opening     \$     -

**SCS & M/WBE Credit Calculation**

A = Maximum Points Allowed

B = Maximum Percentage Bid by any Proposer (0% to 100%)

C = Percentage Bid by Proposer

Points Awarded =  $(C/B) \times A$

Maximum Percentage Bid – SCS     0

Maximum Percentage Bid – W/MBE     0



Project No: 113458

Exhibit C

Bond No: \_\_\_\_\_

Contract No: 999999

**PAYMENT BOND**

(Subcontract)

KNOW ALL MEN BY THESE PRESENTS, That \_\_\_\_\_ of \_\_\_\_\_, \_\_\_\_\_, \_\_\_\_\_ (hereinafter called the "Principal"), as Principal and \_\_\_\_\_

a corporation organized and existing under the laws of the State of \_\_\_\_\_, (hereinafter called the "Surety"), as Surety, are held and firmly bound unto **CLARK CONSTRUCTION GROUP, LLC, 180 HOWARD STREET, SUITE 1200, SAN FRANCISCO, CA 94105** (hereinafter called the "Obligee"), in the sum of **ZERO DOLLARS (\$0.00)**, for the payment of which sum well and truly to be made, the said Principal and Surety bind themselves, and their respective heirs, administrators, executors, successors and assigns, jointly and severally, firmly by these presents.

WHEREAS, the Obligee has been awarded a contract (hereinafter called the "Prime Contract"), by **PORT OF SEATTLE, 2711 ALASKAN WAY., SEATTLE, WA 98121** for **DESIGN/BUILD SERVICES FOR INTERNATIONAL ARRIVALS FACILITY, SEATTLE, WA** and;

WHEREAS, the Principal has entered into a written Subcontract with the Obligee, dated **DECEMBER 31, 2050** to perform, as Subcontractor, certain portions of the work in connection with said Prime Contract, consisting of the work described in Exhibit B and elsewhere in the Subcontract, which Subcontract is hereby referred to and made a part hereof.

NOW, THEREFORE, THE CONDITION OF THIS OBLIGATION IS SUCH, that if the Principal shall promptly make payment to all persons supplying labor and material in the prosecution of the work provided for in said Subcontract and any and all modifications of said Subcontract that may hereafter be made, then this obligation shall be null and void; otherwise it shall remain in full force and effect.

The said Surety agrees that no change, extension of time, alteration, addition, omission, or other modification of the terms of either the said Subcontract or the said Prime Contract, or both, or in the said work to be performed, or in the specifications, or in the plans, shall in anywise affect its obligation on this Bond, and it does hereby waive notice of any such changes, extensions of time, alterations, additions, omissions, and other modifications. Furthermore, any increase in the Subcontract amount shall automatically result in a corresponding increase in the penal amount of this Bond without notice to, or consent from, the Surety, such notice and consent hereby being waived. Decreases in the Subcontract amount shall not, however, reduce the penal amount of this Bond unless expressly consented to by Obligee in writing.

The said Principal and the said Surety agree that this Bond shall inure to the benefit of all persons supplying labor and material in the prosecution of the work provided for in said Subcontract, as well as to the Obligee, and that such persons may maintain independent actions upon this Bond in their own names.

IN WITNESS WHEREOF, the above bounden parties have executed this instrument under their several seals this \_\_\_\_\_ day of \_\_\_\_\_, 20\_\_\_\_, the name and corporate seal of each corporate party being hereto affixed and these presents duly signed by its undersigned representative, pursuant to authority of its governing body.

\_\_\_\_\_  
\_\_\_\_\_  
(Principal) (Seal)

\_\_\_\_\_  
\_\_\_\_\_  
(Business Address)

Witness:

\_\_\_\_\_  
Or Secretary's Attest

By \_\_\_\_\_  
(Signature) (Title)

\_\_\_\_\_  
(Surety) (Seal)

\_\_\_\_\_  
(Business Address)

Witness:

\_\_\_\_\_  
Or Secretary's Attest

By \_\_\_\_\_  
(Signature) (Title)

Project No: 113458

Exhibit C

Bond No: \_\_\_\_\_

Contract No: 999999

**PERFORMANCE BOND**  
**(Subcontract)**

KNOW ALL MEN BY THESE PRESENTS, That \_\_\_\_\_ of \_\_\_\_\_, \_\_\_\_\_, \_\_\_\_\_ (hereinafter called the "Principal"), as Principal and \_\_\_\_\_

\_\_\_\_\_ a corporation organized and existing under the laws of the State of \_\_\_\_\_, (hereinafter called the "Surety"), as Surety, are held and firmly bound unto **CLARK CONSTRUCTION GROUP, LLC, 180 HOWARD STREET, SUITE 1200, SAN FRANCISCO, CA 94105** (hereinafter called the "Obligee"), in the sum of **ZERO DOLLARS (\$0.00)**, for the payment of which sum well and truly to be made, the said Principal and Surety bind themselves, and their respective heirs, administrators, executors, successors and assigns, jointly and severally, firmly by these presents.

WHEREAS, the Obligee has been awarded a contract (hereinafter called the "Prime Contract"), by **PORT OF SEATTLE, 2711 ALASKAN WAY., SEATTLE, WA 98121** for **DESIGN/BUILD SERVICES FOR INTERNATIONAL ARRIVALS FACILITY, SEATTLE, WA** and;

WHEREAS, the Principal has entered into a written Subcontract with the Obligee, dated **DECEMBER 31, 2050** to perform, as Subcontractor, certain portions of the work in connection with said Prime Contract, consisting of the work described in Exhibit B and elsewhere in the Subcontract, which Subcontract is hereby referred to and made a part hereof.

NOW, THEREFORE, THE CONDITION OF THIS OBLIGATION IS SUCH, that if the above bounden Principal shall well and truly perform all the undertakings, covenants, terms, conditions, and agreements of said Subcontract within the time provided therein and any extensions thereof that may be granted by the Obligee, and during the life of any guaranty required under said Subcontract, and shall also well and truly perform all the undertakings, covenants, terms, conditions, and agreements of any and all duly authorized modifications of said Subcontract that may hereafter be made, and shall indemnify and save harmless said Obligee of and from any and all loss, damage, and expense, including costs and attorney's fees, which the said Obligee may sustain by reason of failure so to do, then this obligation shall be null and void; otherwise it shall remain in full force and effect.

The said Surety agrees that no change, extension of time, alteration, addition, omission, or other modification of the terms of either the said Subcontract or the said Prime Contract, or both, or in the said work to be performed, or in the specifications, or in the plans, shall in anywise affect its obligation on this Bond, and it does hereby waive notice of any such changes, extensions of time, alterations, additions, omissions, and other modifications. Furthermore, any increase in the Subcontract amount shall automatically result in a corresponding increase in the penal amount of this Bond without notice to, or consent from, the Surety, such notice and consent hereby being waived. Decreases in the Subcontract amount shall not, however, reduce the penal amount of this Bond unless expressly consented to by Obligee in writing.

IN WITNESS WHEREOF, the above bounden parties have executed this instrument under their several seals this \_\_\_\_\_ day of \_\_\_\_\_, 20\_\_\_\_, the name and corporate seal of each corporate party being hereto affixed and these presents duly signed by its undersigned representative, pursuant to authority of its governing body.

\_\_\_\_\_  
\_\_\_\_\_  
(Principal) (Seal)

\_\_\_\_\_  
\_\_\_\_\_  
(Business Address)

Witness:

\_\_\_\_\_  
Or Secretary's Attest

By \_\_\_\_\_  
(Signature) (Title)

\_\_\_\_\_  
(Surety) (Seal)

\_\_\_\_\_  
(Business Address)

Witness:

\_\_\_\_\_  
Or Secretary's Attest

By \_\_\_\_\_  
(Signature) (Title)



DESIGN/BUILD SERVICES FOR INTERNATIONAL ARRIVALS FACILITY SEATTLE, WA

EXHIBIT E (09/15/2015)

Clark Project No.: 113458 - Applies only to early start work

The information noted below sets forth the insurance required by the Subcontract Agreement. Subcontractor is responsible for complying with all insurance requirements outlined in this Exhibit E unless specifically agreed to in writing by an Officer of Clark.

Upon execution of this Agreement, Subcontractor shall procure (at its sole cost and expense), maintain, and evidence, insurance coverages set forth below that conform to the following minimum limits, terms and conditions:

1) Additional Insureds

Clark Construction Group, LLC (hereinafter "Clark") and the Port of Seattle are to be added as additional insureds on all policies required in section 2 below, except Workers' Compensation and Employer's Liability.

The additional insured coverage shall be provided via the ISO CG 20 10 (11/85) or CG 20 10 (10/93) AND CG 20 37 (07/04) or CG 20 10 (10/01) AND CG 20 37 (10/01) additional insured endorsement(s), or its equivalent. Additional insured coverage shall extend to the entities listed above for a period of ten years or the statute of repose in the state in which this PROJECT IS LOCATED, whichever is less. The additional insured endorsement form number used in your policy must be identified on the certificate of insurance. A copy of the additional insured endorsement must be provided if it is a manuscript endorsement. Clark reserves the right to request a copy of any additional insured endorsement(s) used in your policy. The additional insured endorsement shall state that the coverage provided to the additional insureds is primary and non-contributing with respects to any other insurance that may be available to the additional insured(s).

2) Minimum acceptable insurance coverage and limits are as follows:

Workers' Compensation Insurance:

Statutory Limit

Subcontractor and all of its subcontractors at any tier performing any work within 500ft of navigable water must purchase, maintain, and evidence coverage for both Jones Act and US Longshore and Harbor Workers' Compensation Act. Coverage and certificates of insurance provided on the behalf of Subcontractor by an employee leasing or other non-affiliated companies are not acceptable.

Employer's Liability Insurance:

Table with 2 columns: Description and Limit. Rows include Bodily Injury by Accident, Disease, and policy limit, all with a limit of \$1,000,000.

Commercial General Liability Insurance (CGL):

CGL coverage form should be the ISO Occurrence Form CG0001 (12/04), or its equivalent. Minimum \$5,000,000 limit can be achieved through a CGL policy as stated above or a combination of CGL policies and following form umbrella excess liability policies. General Aggregate Limit shall be endorsed to apply per project/per location.

Table with 2 columns: Description and Limit. Rows include Each Occurrence Limit, General Aggregate Limit, and Products & Completed Operations Aggregate, all with a limit of \$5,000,000.

Comprehensive Auto Liability:

Table with 2 columns: Description and Limit. Row includes Combined Single Limit for covering all owned, non-owned, and hired vehicles including MCS90s, with a limit of \$1,000,000.



**EXHIBIT E**  
**(09/15/2015)**

3) Professional Liability Insurance:

In the event the Subcontractor or any of its subcontractors at any tier are required by Subcontract to provide design services or the services of a professional engineer, including but not limited to sealing or certifying documents, then Subcontractor or any one of such subcontractors at any tier shall procure, maintain, and evidence professional liability insurance written on either claims made or occurrence coverage form with minimum policy limits detailed below. Insurance evidenced on a claims made coverage form must include extended reporting periods or retroactive dates corresponding with the Statute of Repose for the State in which the Project is located.

**Mechanical, Electrical, Plumbing, Fire Protection subcontractors:**

Each Claim	<b>\$5,000,000</b>
Aggregate Limit of Liability	<b>\$5,000,000</b>

**All other subcontractors:**

Each Claim	<b>\$1,000,000</b>
Aggregate Limit of Liability	<b>\$1,000,000</b>

Subcontractor shall provide, or in the case of any of its subcontractors of any tier providing Professional Liability Coverage, **shall cause** any of such subcontractors to provide, Clark with a certificate of insurance confirming the existence of insurance coverages set forth in this Exhibit E.

Certificates for any tiered subcontractor performing Professional Liability must name Clark as a certificate holder and include the following information on the certificate: TIERED SUBCONTRACTOR for Subcontractor name: job number and job name.

4) Hazardous Material Abatement Coverage:

In the event the Subcontractor or any of its subcontractors at any tier are performing any demolition of pre-existing structures, excavation, moving or removal of any hazardous materials, or handling of any hazardous materials, this Subcontractor, and any such lower-tier subcontractors, shall procure, maintain, and evidence the Hazardous Material Abatement Coverage outlined in 4a. and 4b. below:

- a) Asbestos and Lead Abatement Liability Coverage written on an occurrence basis with no sunset clause (for the abatement of asbestos and lead). Minimum policy limits of liability are:
 

Each Occurrence Limit	<b>\$2,000,000</b>
Aggregate Limit of Liability	<b>\$2,000,000</b>
  
- b) Contractor's Pollution Liability Coverage (for the abatement and handling of all hazardous and contaminated materials other than asbestos and/or lead). This may be written on a claims made or occurrence coverage form. Minimum policy limits of liability are:
 

Each Occurrence Limit	<b>\$2,000,000</b>
Aggregate Limit of Liability	<b>\$2,000,000</b>
  
- c) Subcontractor will assure that the party transporting any of the materials listed in 4a. and 4b. above will provide the following minimum limits of liability:
 

General Liability	<b>\$2,000,000</b>
Auto Liability	<b>\$2,000,000</b>
Covering all owned, non-owned, and hired vehicles including MCS90s	
Workers Compensation	<b>Statutory</b>
  
- d) Subcontractor will assure that any disposal site used to dispose of hazardous material will provide the following minimum limits of liability:



DESIGN/BUILD SERVICES FOR INTERNATIONAL ARRIVALS FACILITY SEATTLE, WA

EXHIBIT E (09/15/2015)

Table with 2 columns: Insurance Type and Amount. Rows include General Liability (\$2,000,000), Environmental Impairment Liability (\$2,000,000), and Workers Compensation (Statutory).

Subcontractor shall provide, or in the case of any of its subcontractors of any tier providing Hazardous Materials Abatement Coverage, shall cause any of such subcontractors to provide, Clark with a certificate of insurance confirming the existence of insurance coverages set forth in this Exhibit E. Certificate of insurance should show the issuing company will mail thirty (30) days written notice of cancellation to Clark.

Certificates for any tiered subcontractor performing Hazardous Materials Abatement Coverage must name Clark as a certificate holder and include the following information on the certificate: TIERED SUBCONTRACTOR for Subcontractor name: job number and job name.

5) Insurance Certificates and Policies

Clark reserves the right to request confirmation of any/all insurance coverages or requirements noted in this Exhibit E or in the Subcontract Agreement. Subcontractor will provide Clark a complete certified copy of any insurance policy(ies) required in this Exhibit E within five (5) business days of a written request for such. All insurance policies carried by the Subcontractor shall be maintained by the Subcontractor at its sole expense, with insurance carriers qualified to do business in the state in which the Project is located and maintaining a rating of not less than A-X from A.M. Best & Co., unless an Officer of Clark, in writing, in his/her sole discretion, accepts a lower Best's rating. Clark reserves the right to reject any insurance policy that is not underwritten by an insurance company that is reasonably acceptable to us, or on a policy form that is reasonably acceptable to us.

Certificate(s) of insurance should show the issuing company will mail thirty (30) days written notice of cancellation to Clark. Clark's review and/or processing of certificates and/or endorsements does not constitute acceptance or compliance with the subcontractor's insurance requirements.

Certificates must contain the job number, job name, contract number and jobsite address.

Forward all Certificates of Insurance to: subcertificates@clarkconstruction.com

9/1/2015 FORM Edition